

Barriers $\phi 40$ type: ZC

TUEGA

DATE	SCALE	FORMAT
September 2014	1:20	A1

Barrier: ZC-1000x1020

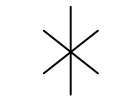
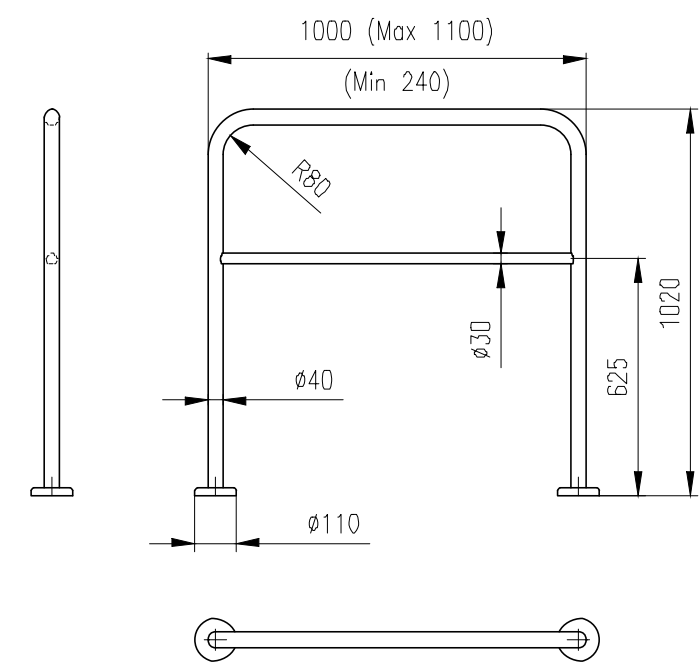

Barrier: ZC-2000x1020

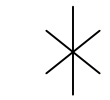
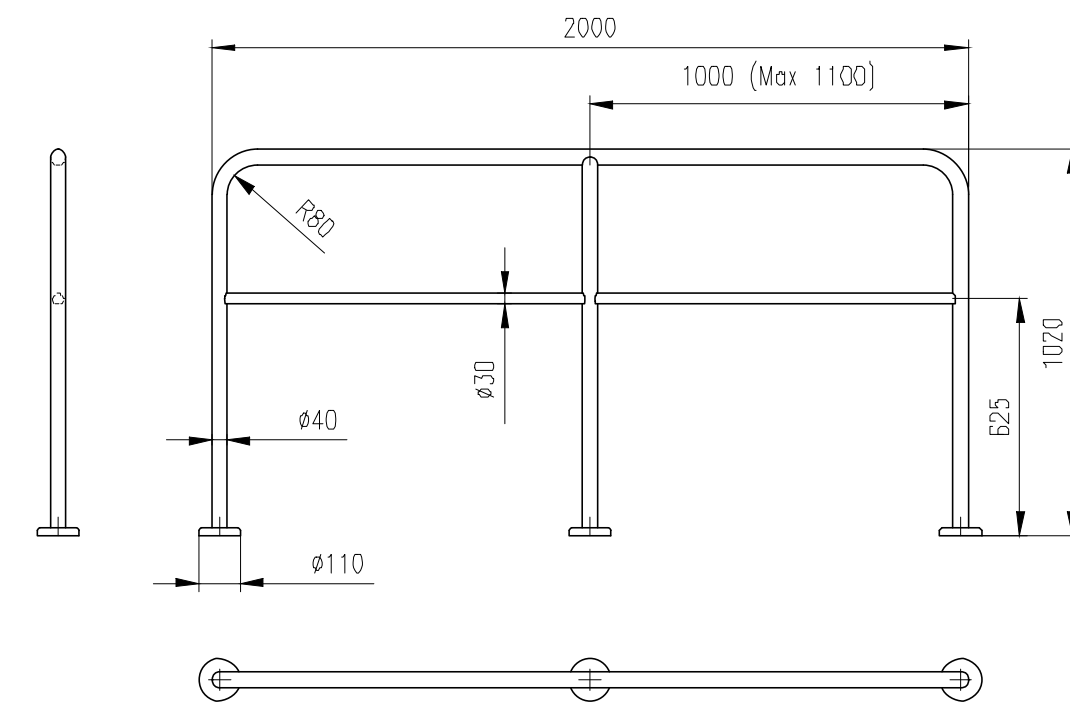

Barrier: ZC-1000+500x1020

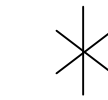
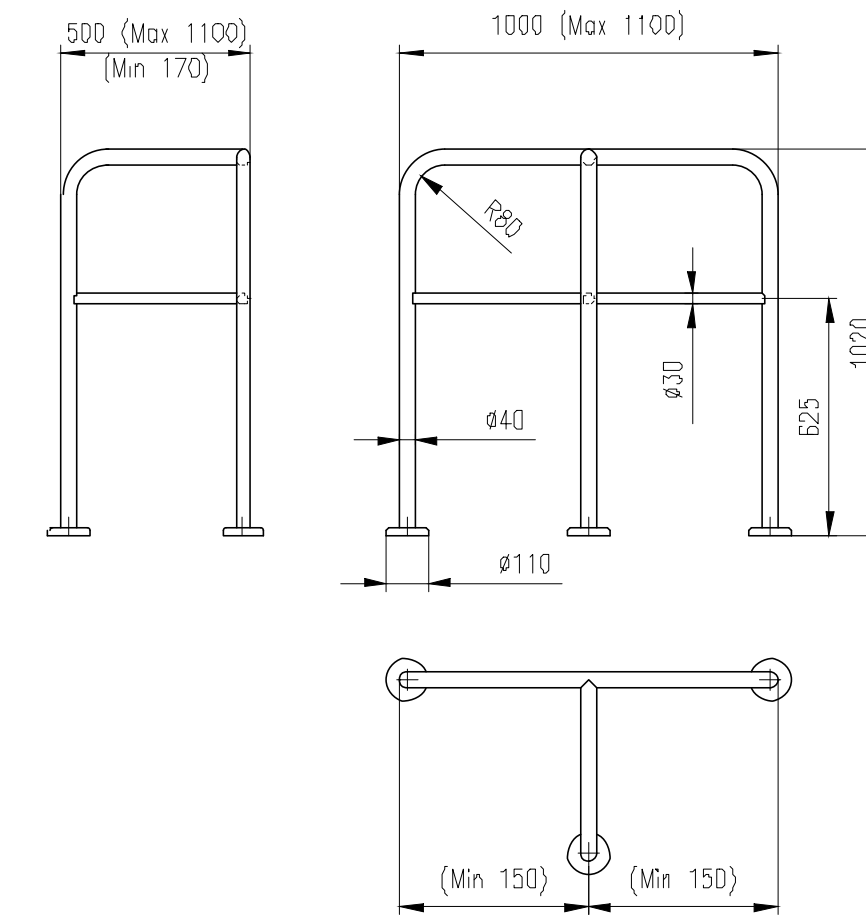

Example of using barrier together with turnstile

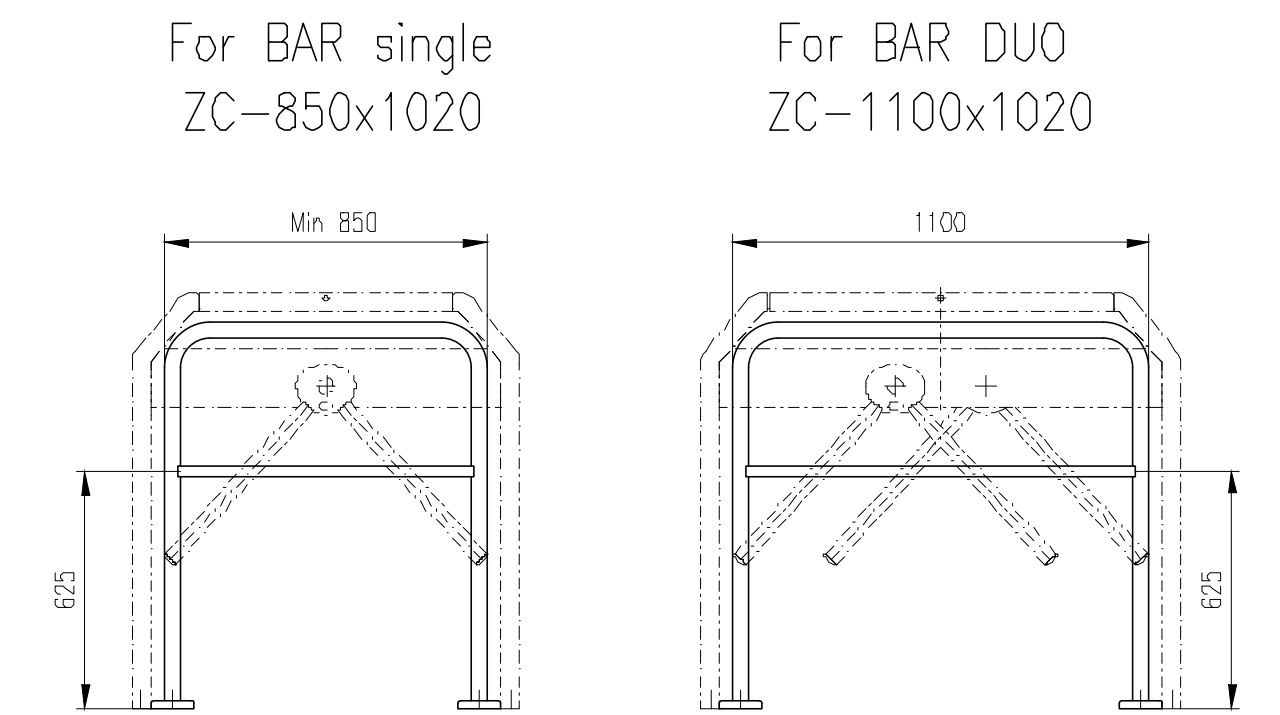

Barrier: ZCT-1000x1020

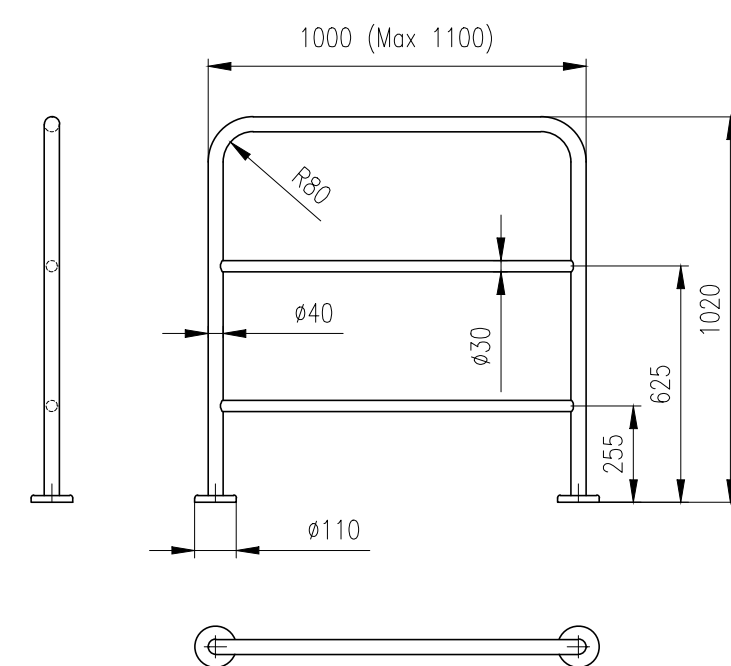

Barrier: ZCT-2000x1020

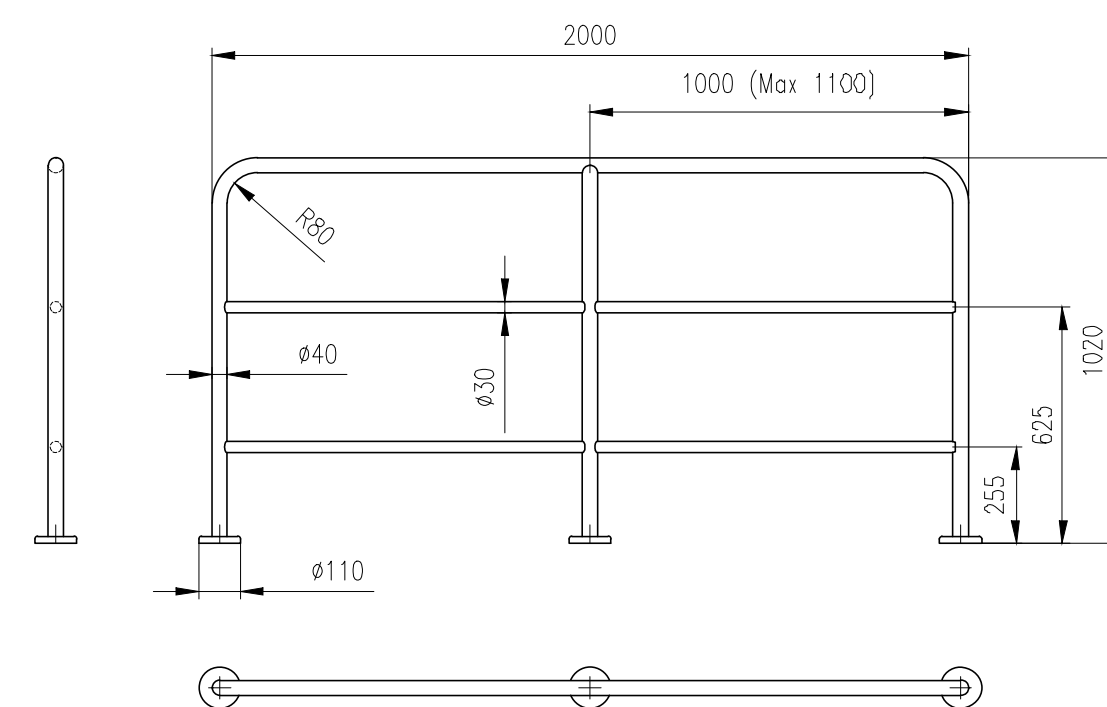

Barrier: ZCS-T-1000x1020

Infill glass panel: Connex 6,4mm

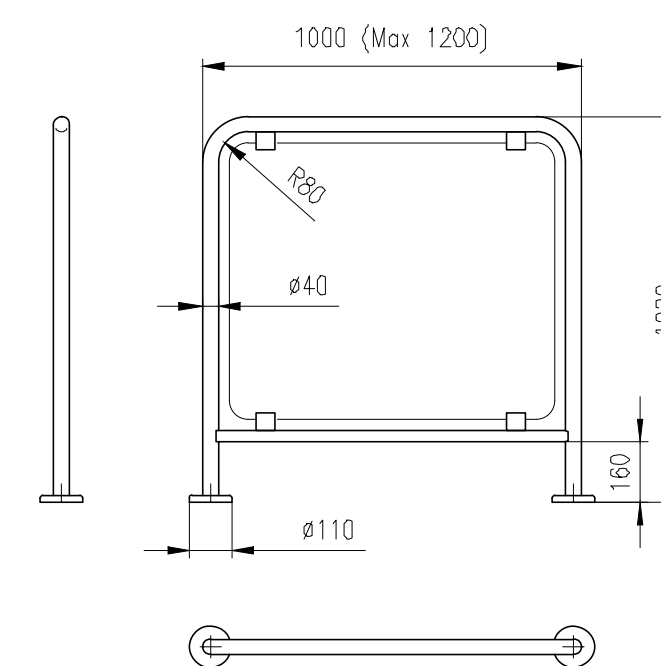

Barrier: ZCS-2000x1020

Infill glass panel: Connex 6,4mm

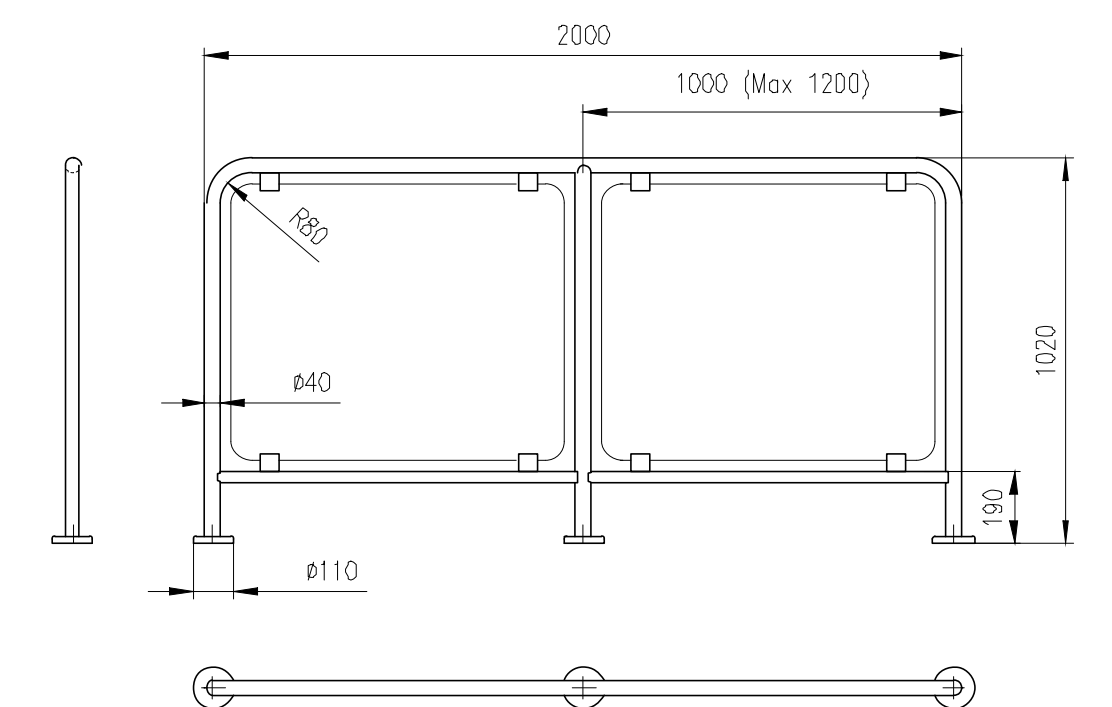

Barrier: ZCS-P-1000x1020

Infill glass panel: Connex 8,4mm

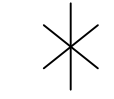
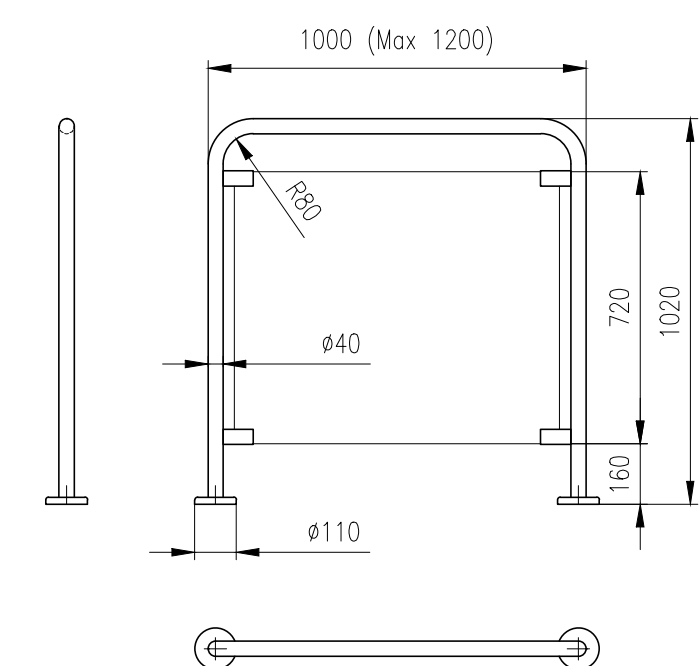

Barrier: ZCS-P-2000x1020

Infill glass panel: Connex 8,4mm

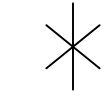
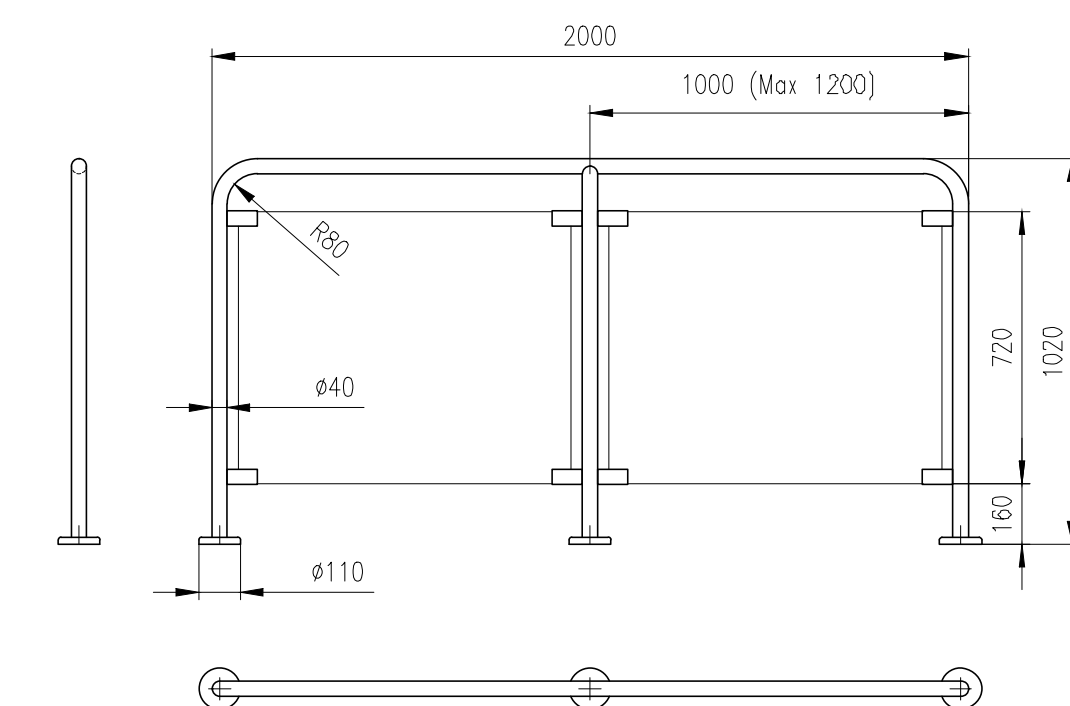

Barrier: ZCS-1000x1020

Infill glass panel: Connex 6,4mm

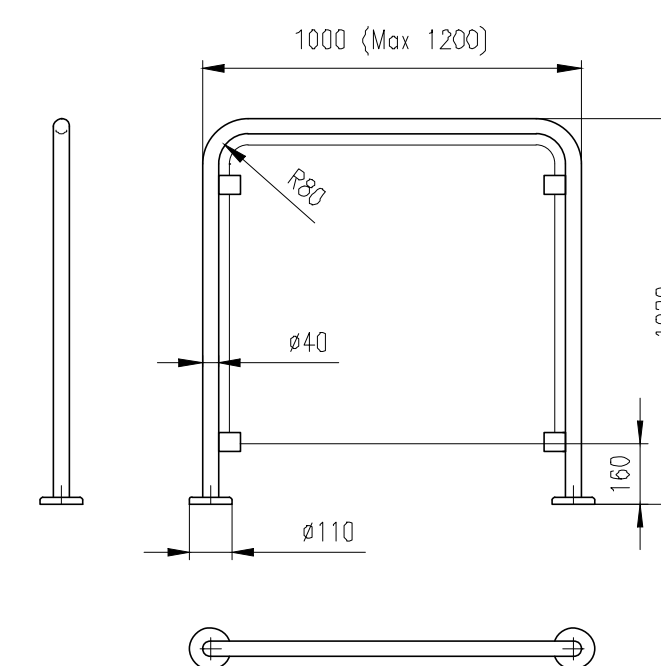

Barrier: ZCS-2000x1020

Infill glass panel: Connex 6,4mm

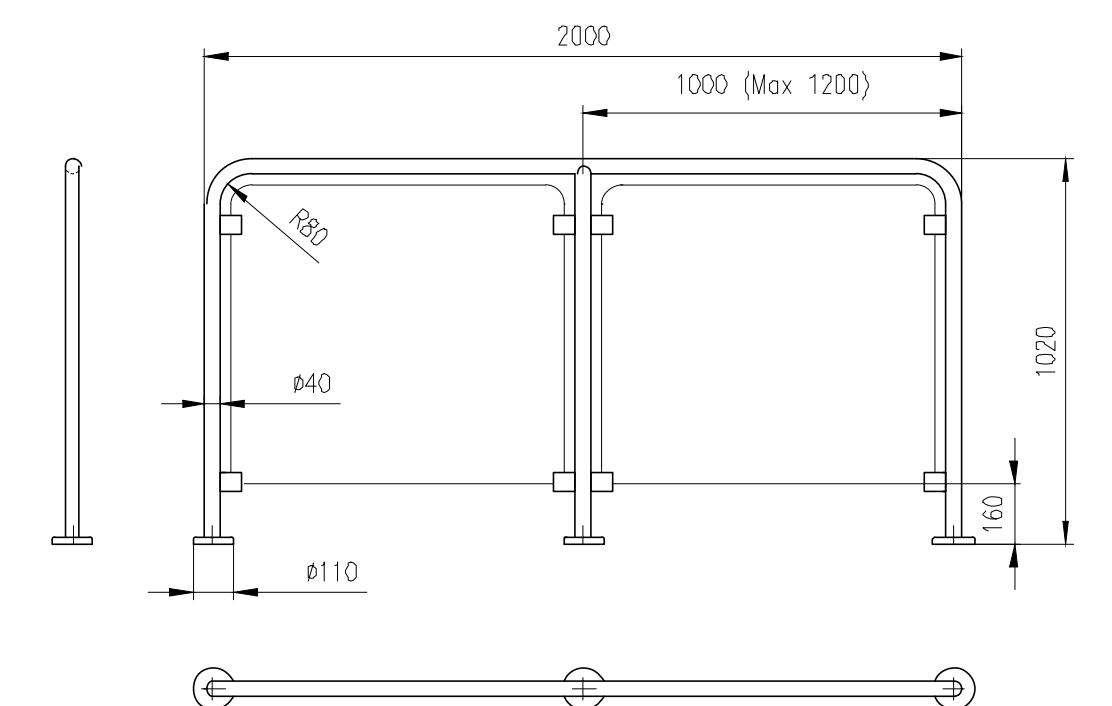

Barriers $\phi 60$ type: ZS

Barrier: ZS-1000x1020/990
 2x side post
 Infill glass panel: Connex 10,4mm

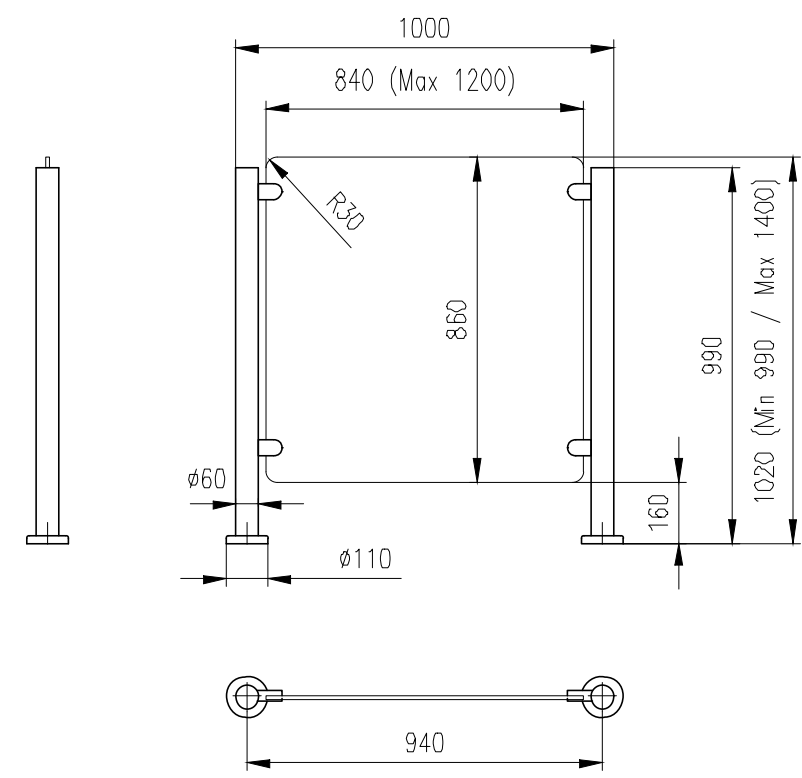

Barrier: ZS-3000x1020/990
 2x side post
 2x middle post 180°
 Infill glass panel: Connex 10,4mm

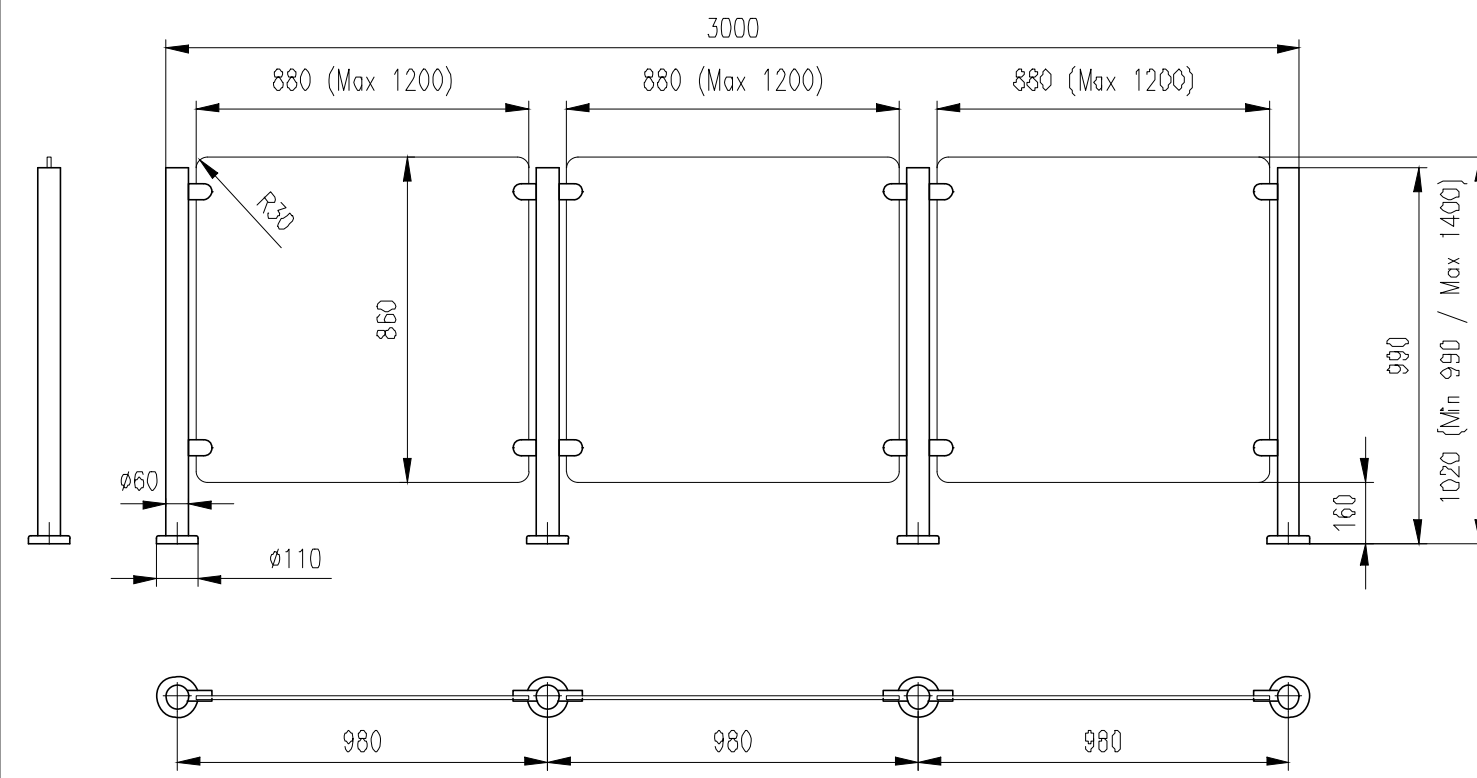

Barrier: ZS-a+b x 1020/990
 Infill glass panel: Connex 10,4mm

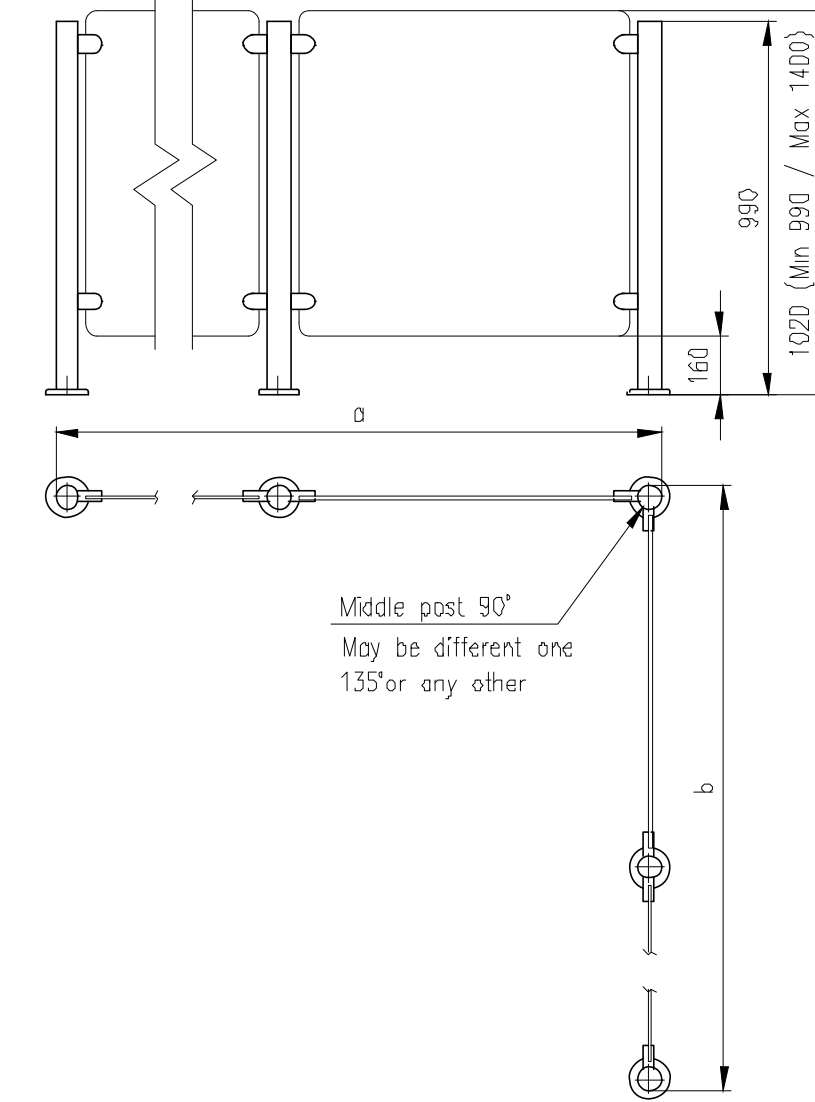

Barrier: ZS-1000x1800/1600
 2x side post
 Infill glass panel: Connex 10,4mm

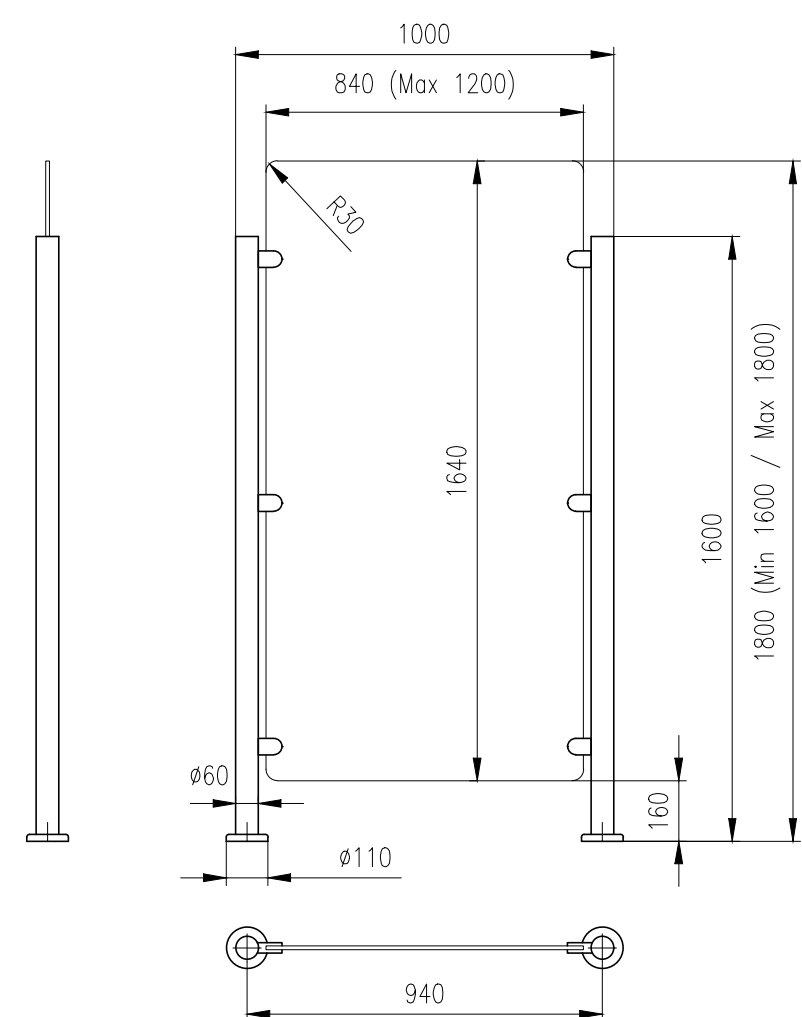

Barrier: ZS-3000x1800/1600
 2x side post
 2x middle post 180°
 Infill glass panel: Connex 10,4mm

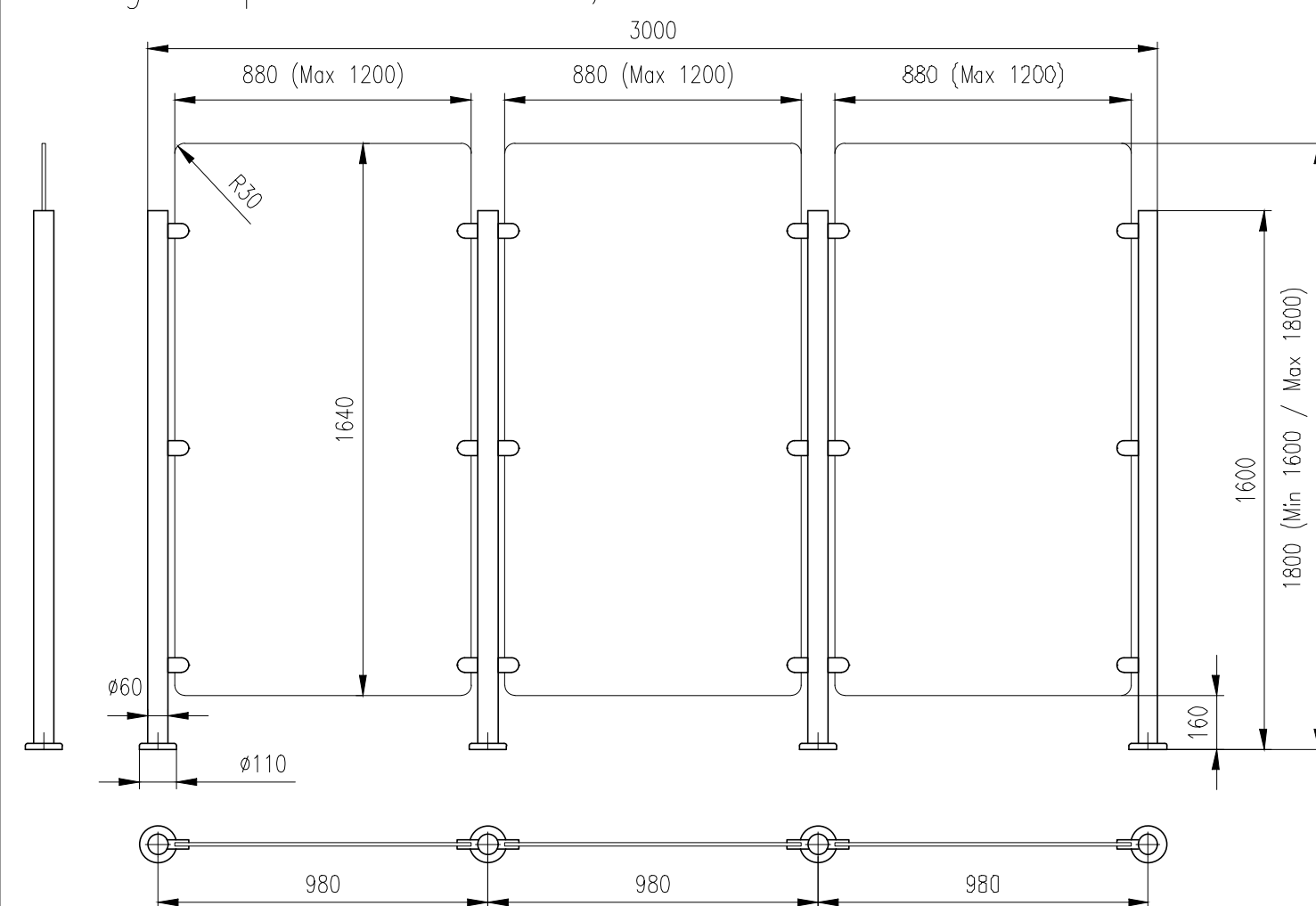

Barrier: ZS-P-1000x1020
 2x side post
 Infill glass panel: Connex 8,4mm

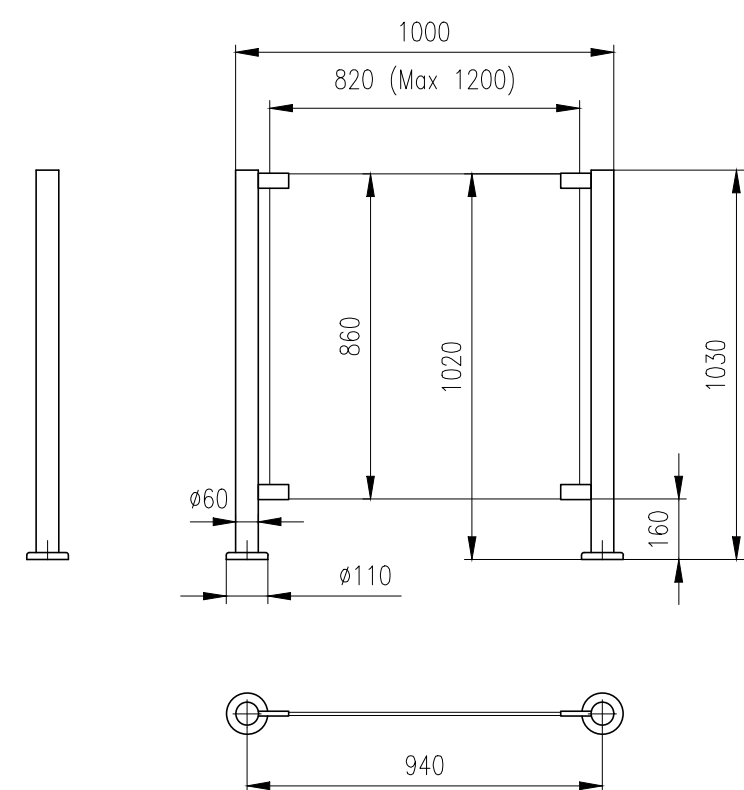

Barrier: ZS-P-3000x1020
 2x side post
 2x middle post 180°
 Infill glass panel: Connex 8,4mm

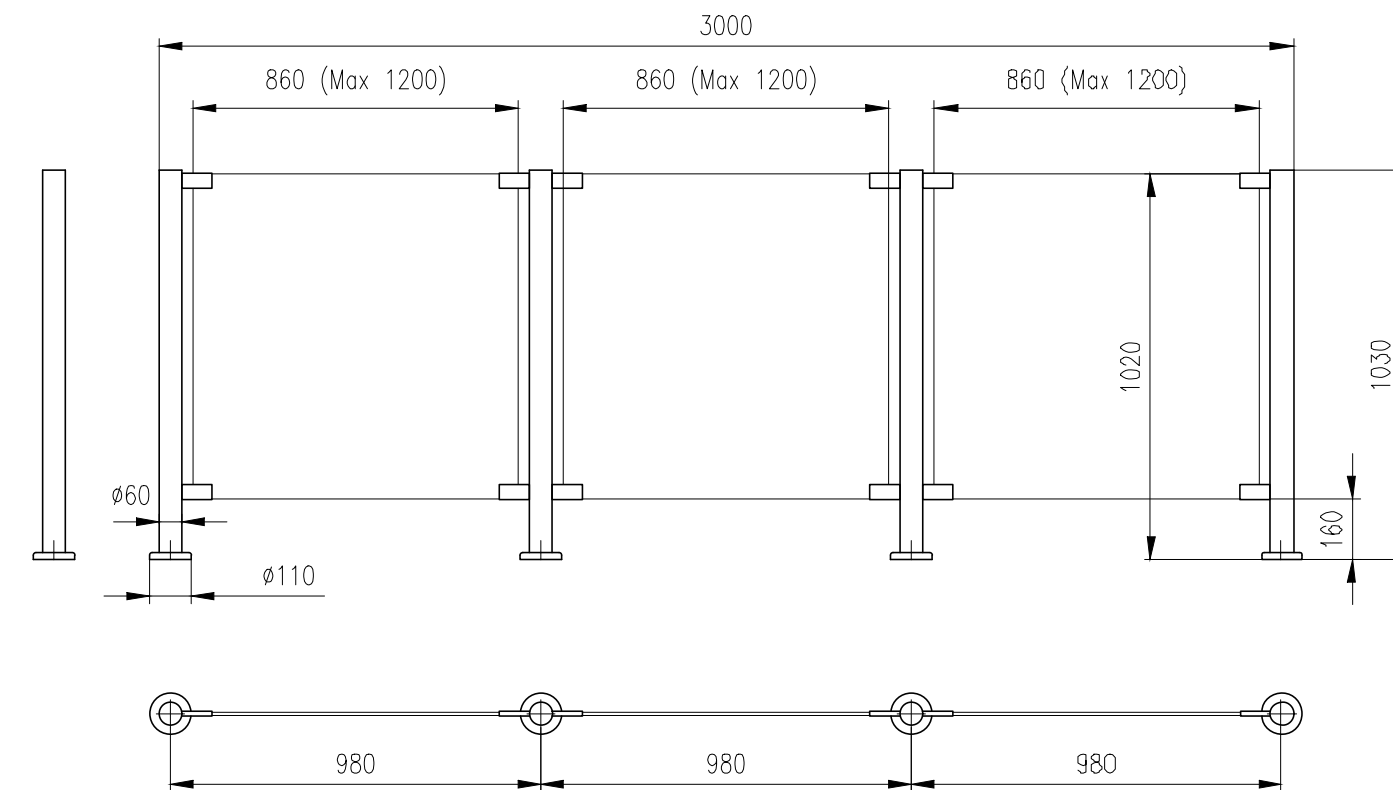

Barrier: ZS-P-a+bx1020
 Infill glass panel: Connex 8,4mm

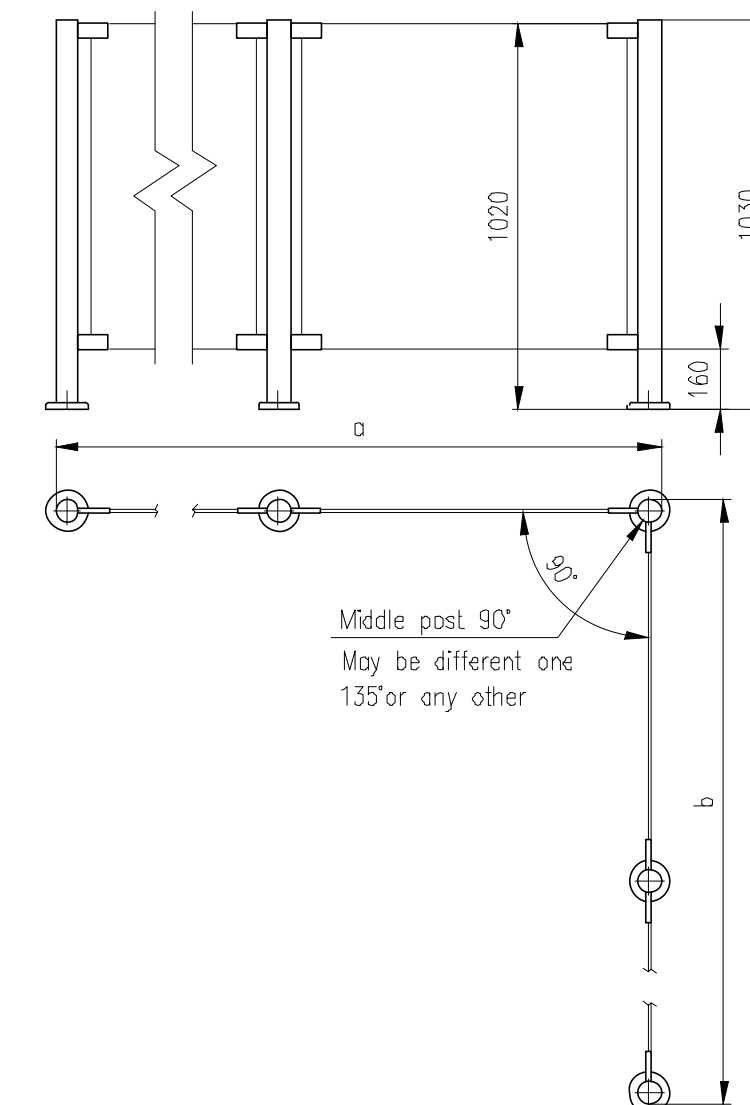

Barriers $\phi 60$ type ZS-H, using together with EASYHATE-HG and HR (Infill glass panel: Connex 10,4mm)

Barrier: ZS-H-1000x1800/1480
2x side post

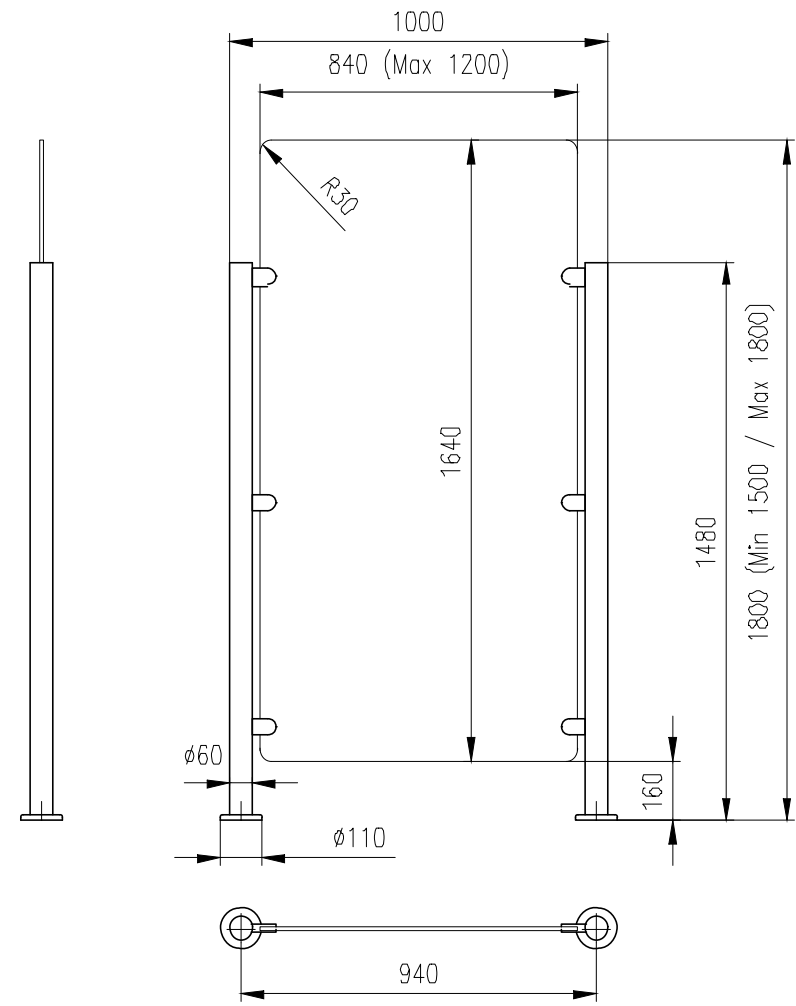

Barrier: ZS-H-3000x1800/1480
2x side post
2x middle post 180°

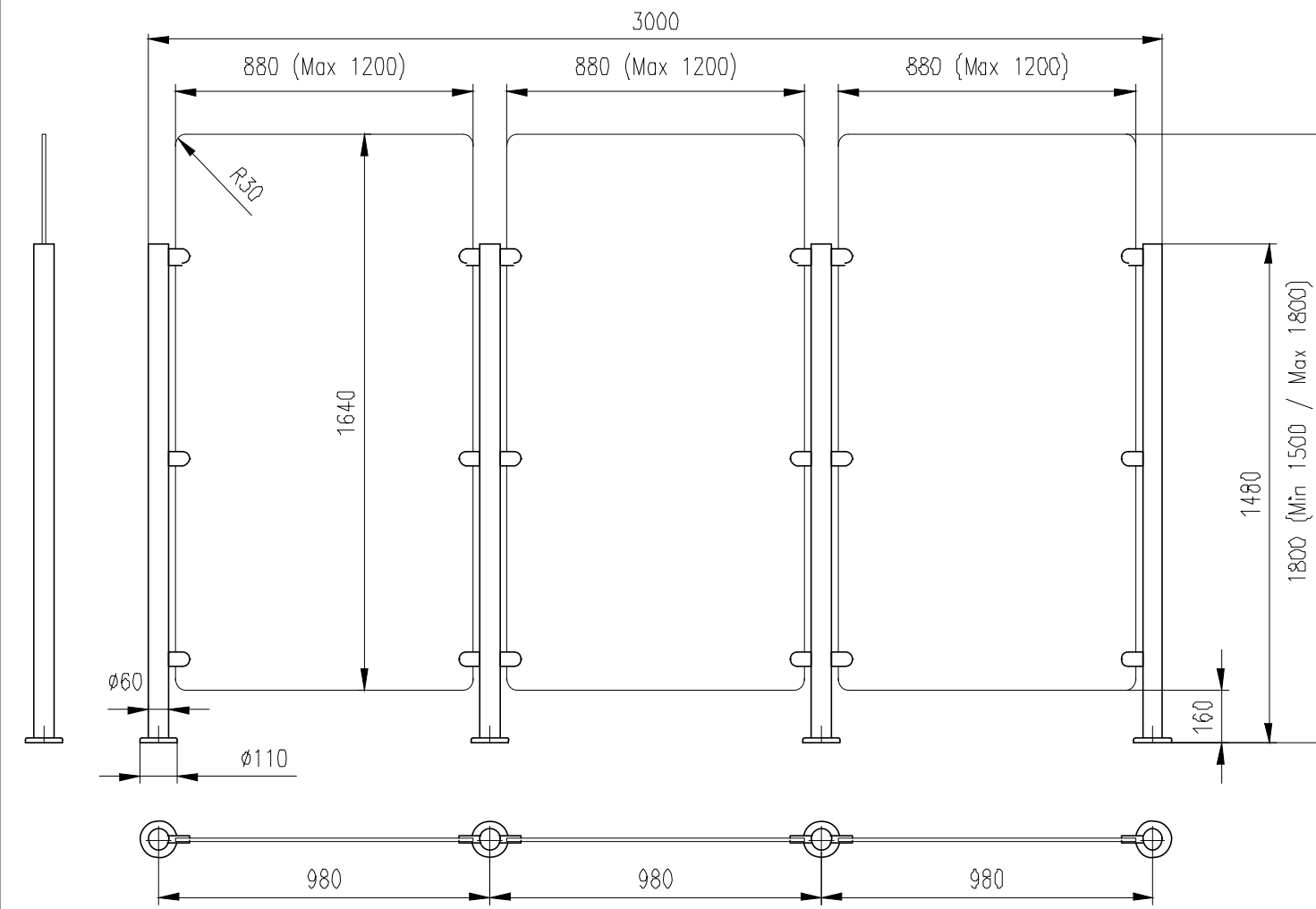

Barrier: ZS-H-1000x1400/1380
2x side post

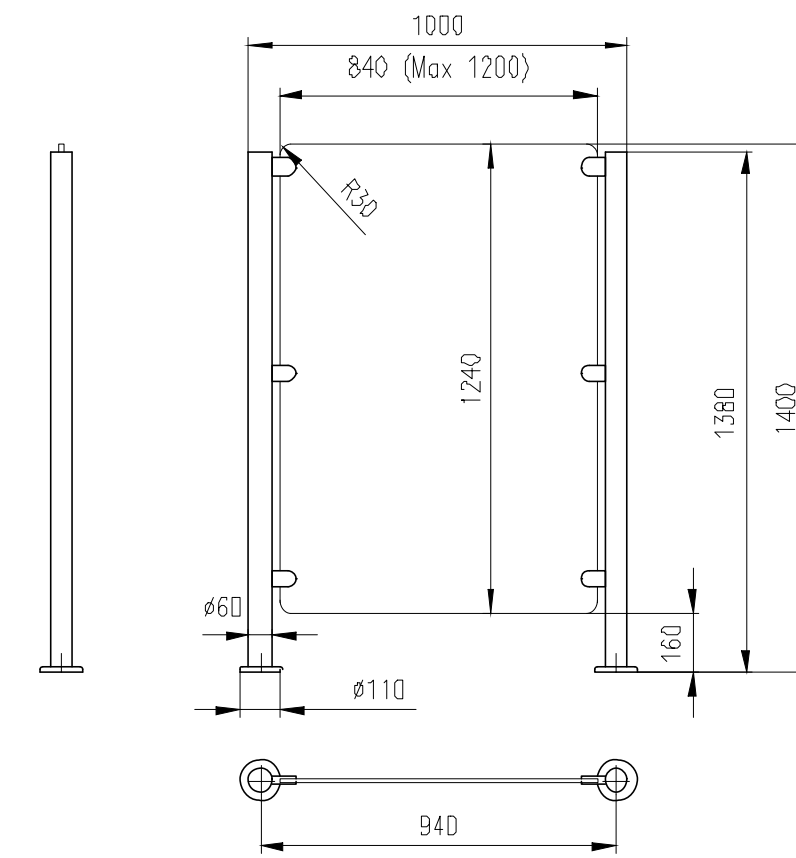

Barrier: ZS-H-3000x1400/1380
2x side post
2x middle post 180°

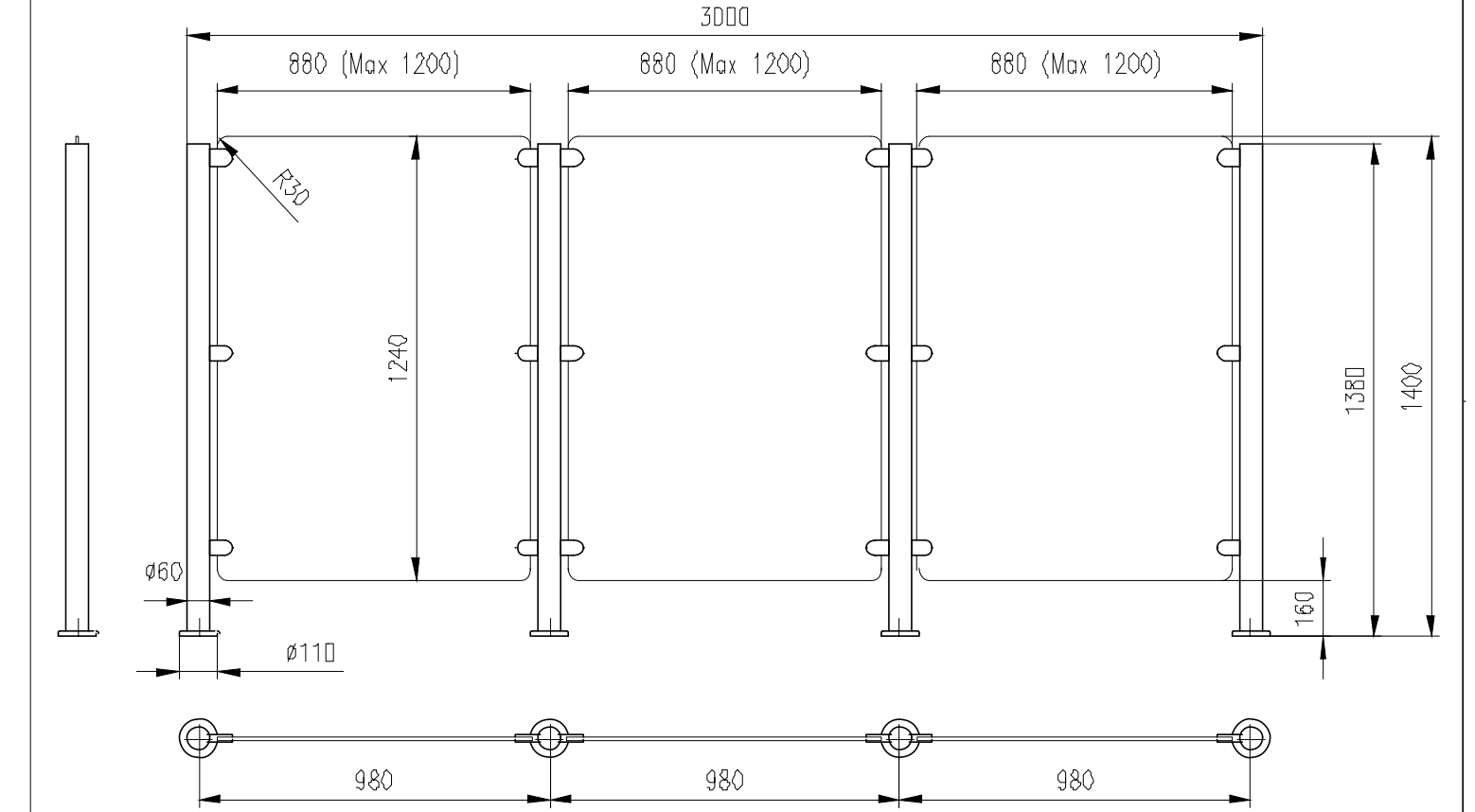

Barrier: ZS-H-1000x1300/1280
2x side post

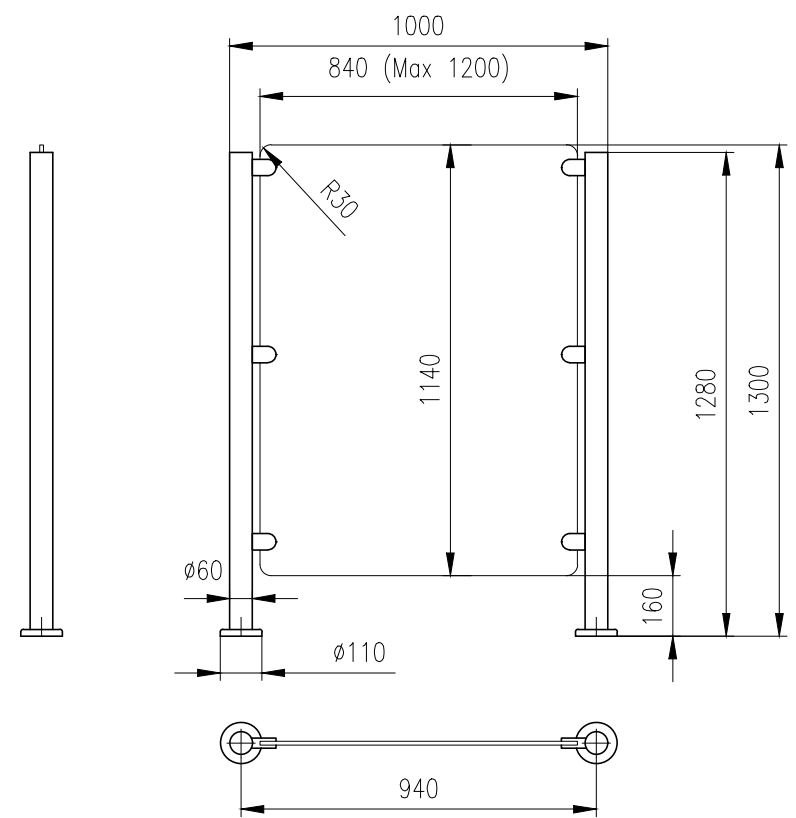

Barrier: ZS-H-3000x1300/1280
2x side post
2x middle post 180°

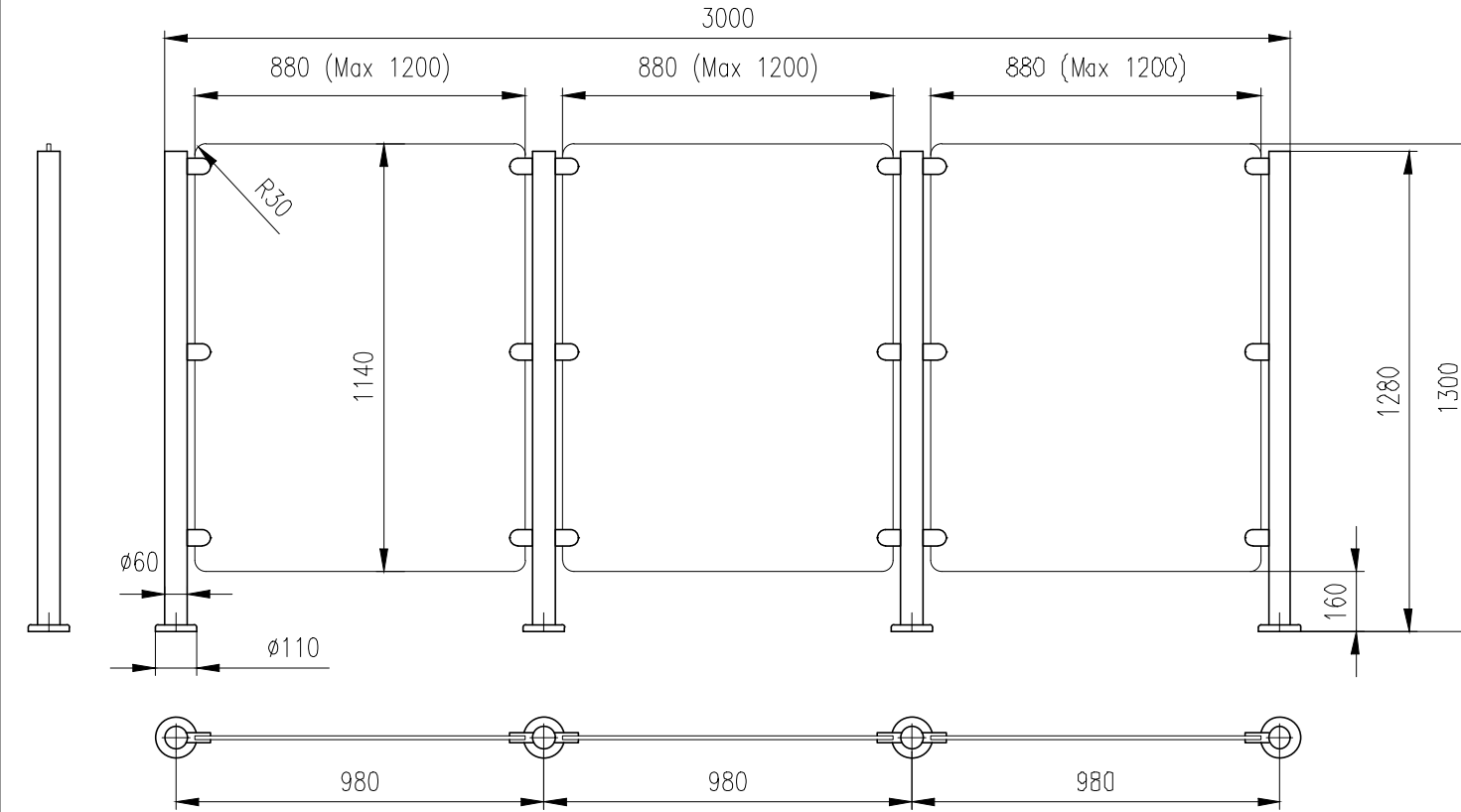

Barrier: ZS-H-1000x1200/1180
2x side post

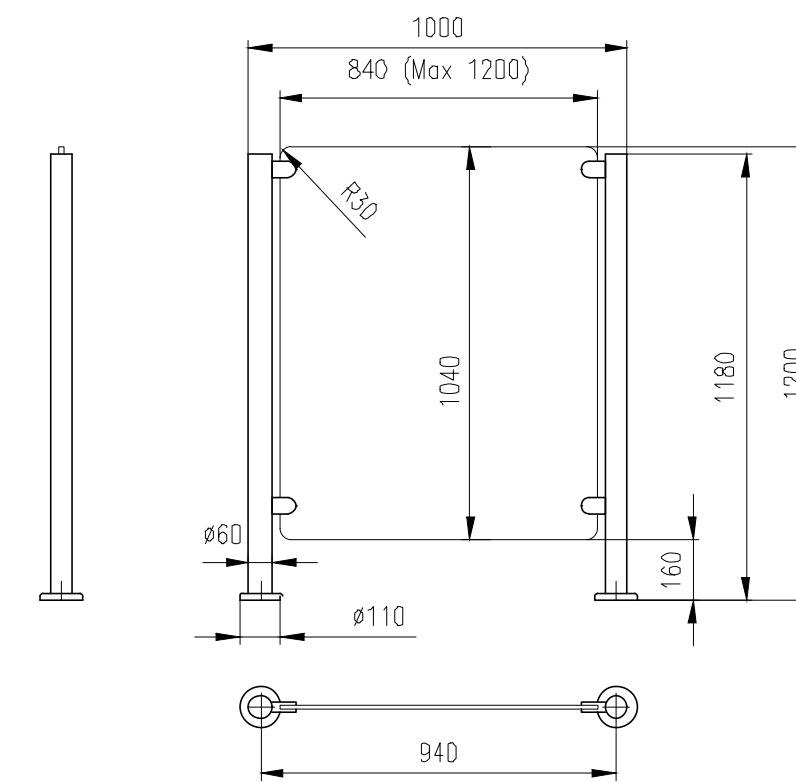

Barrier: ZS-H-3000x1200/1180
2x side post
2x middle post 180°

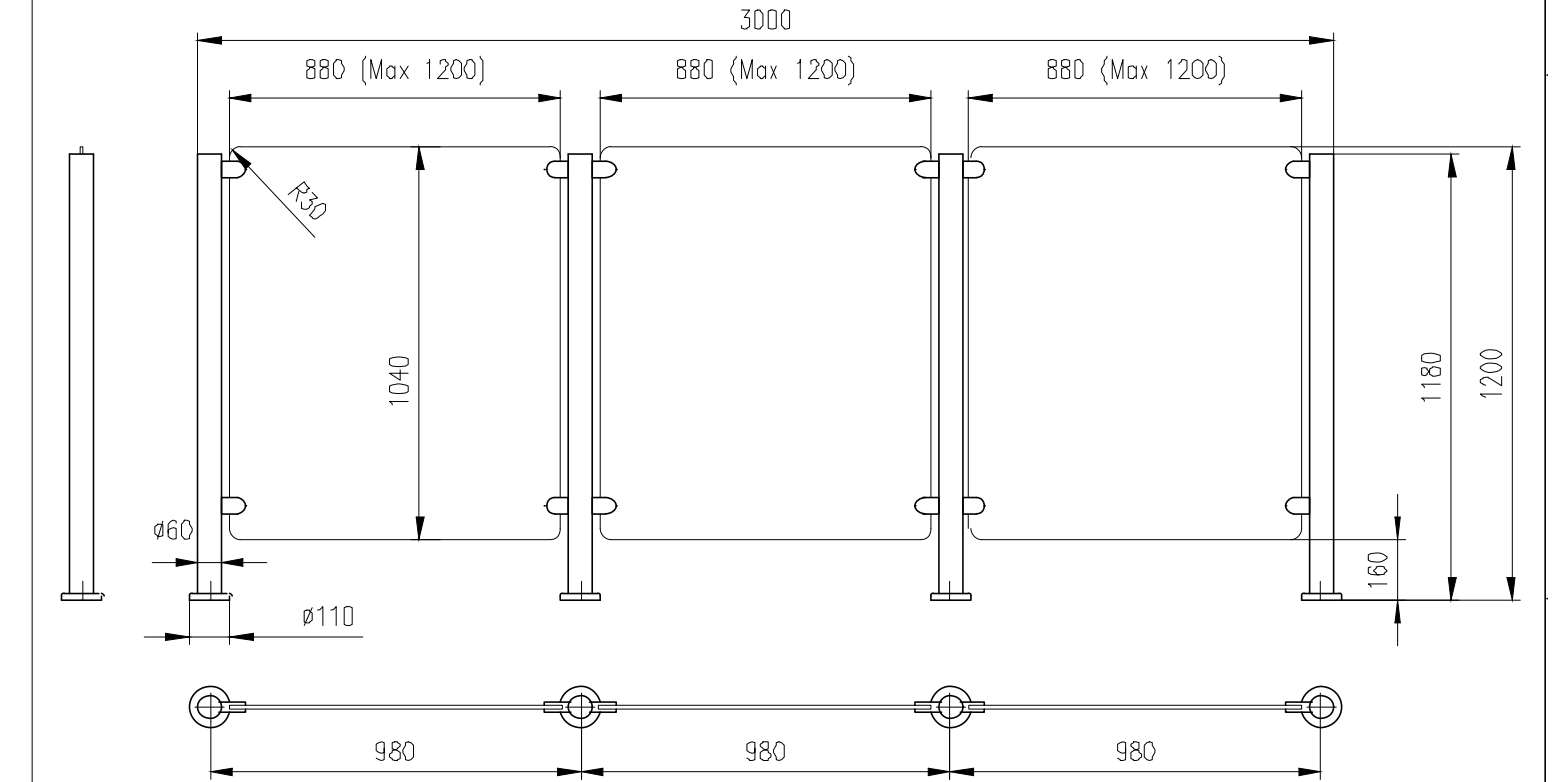

Barrier: ZS-H-1000x1100/1080
2x side post

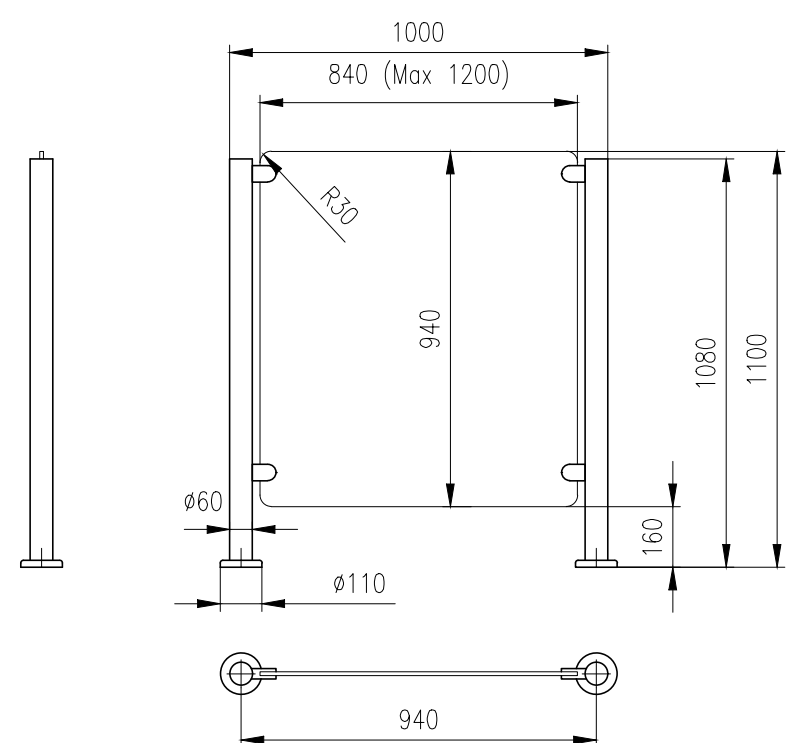

Barrier: ZS-H-3000x1100/1080
2x side post
2x middle post 180°

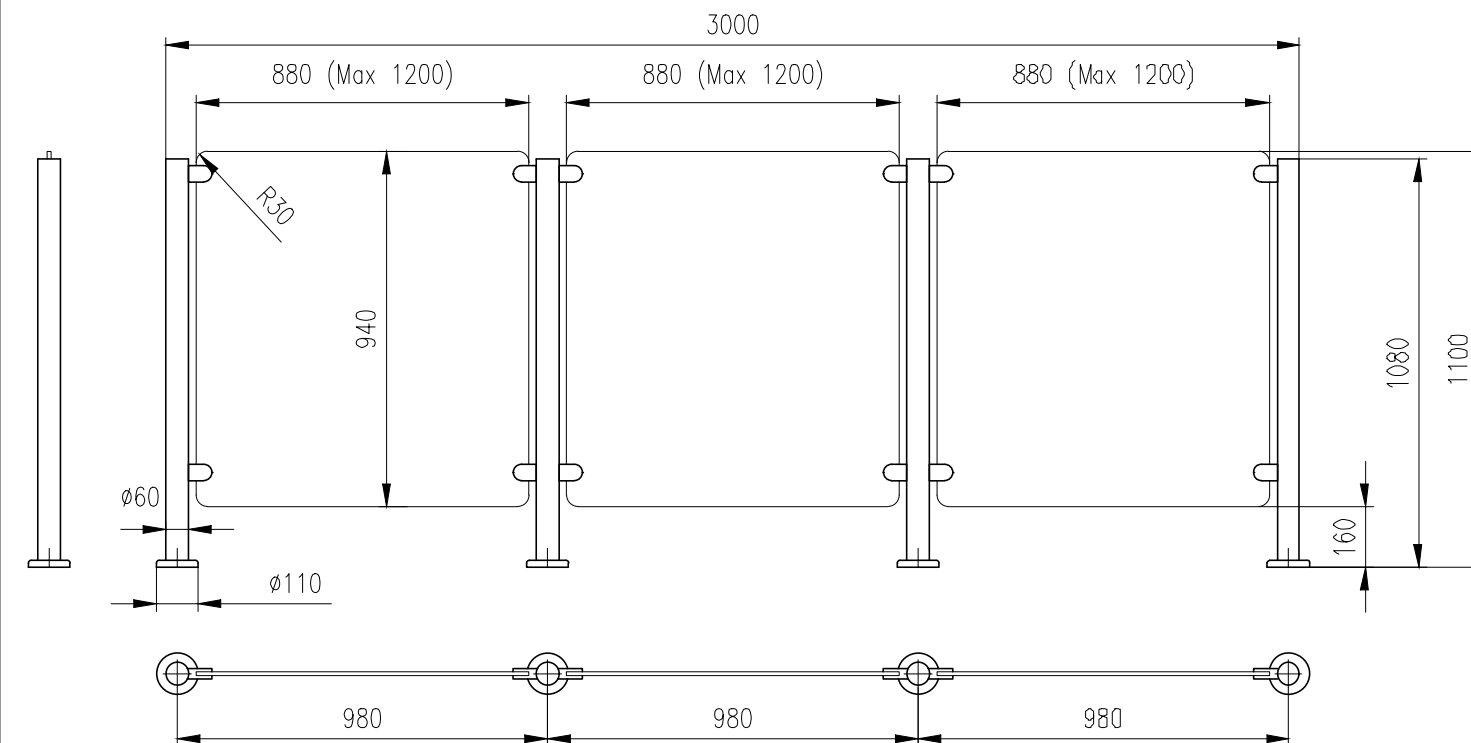

Barrier: ZS-H-1000x975
2x side post

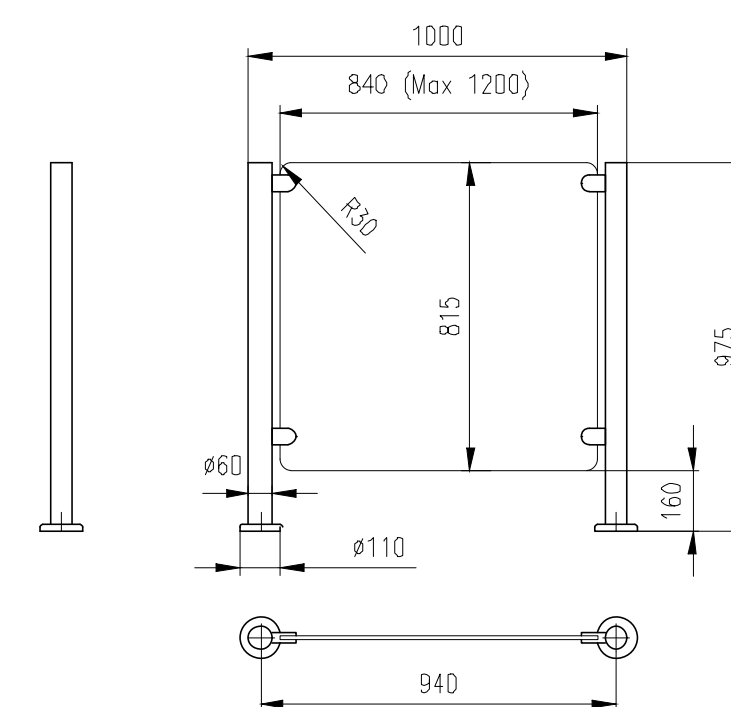

Barrier: ZS-H-3000x975
2x side post
2x middle post 180°

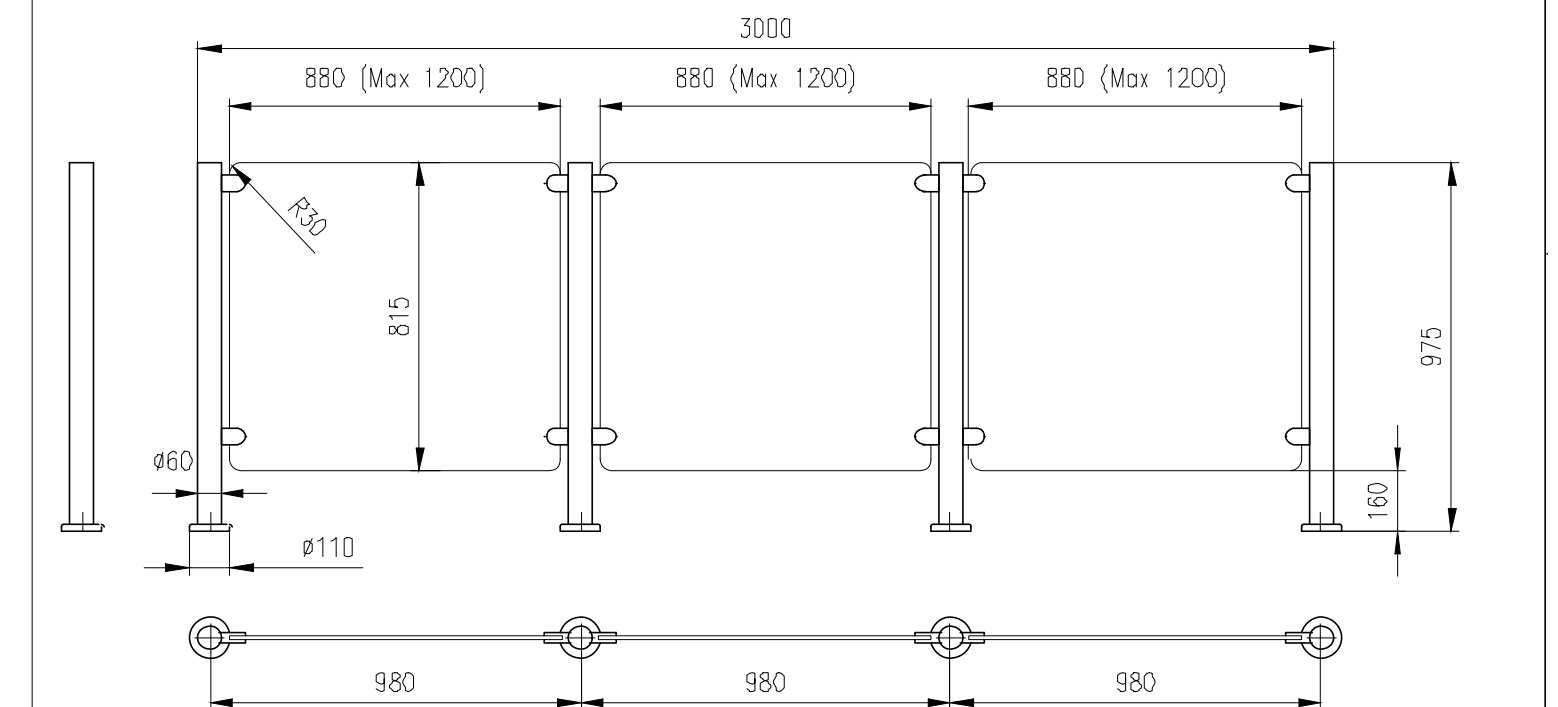

Barriers $\phi 60$ type ZST, using together with BAR-ST

Barrier: ZST-1000x1100

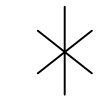
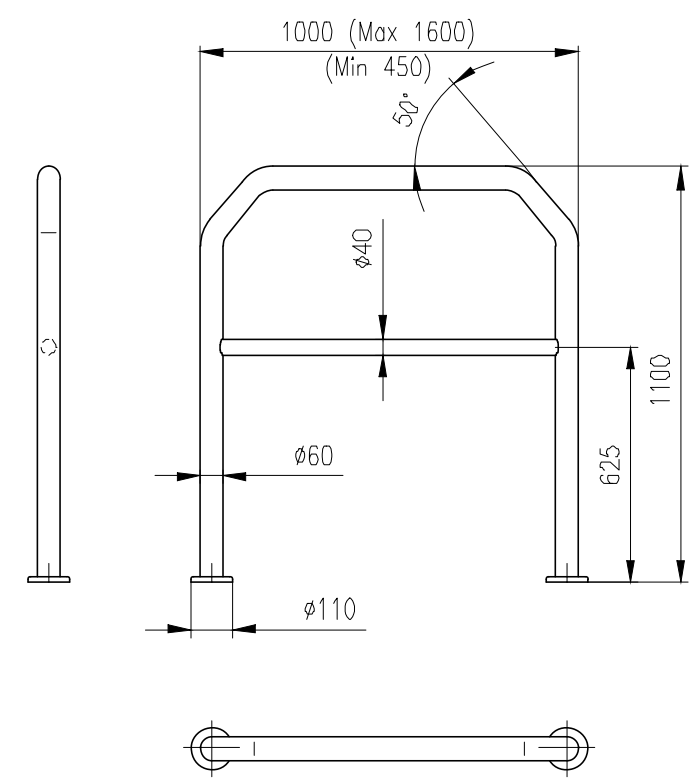

Barrier ZST-1030x1100 for well-directed gateway through the turnstile BAR-ST

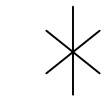
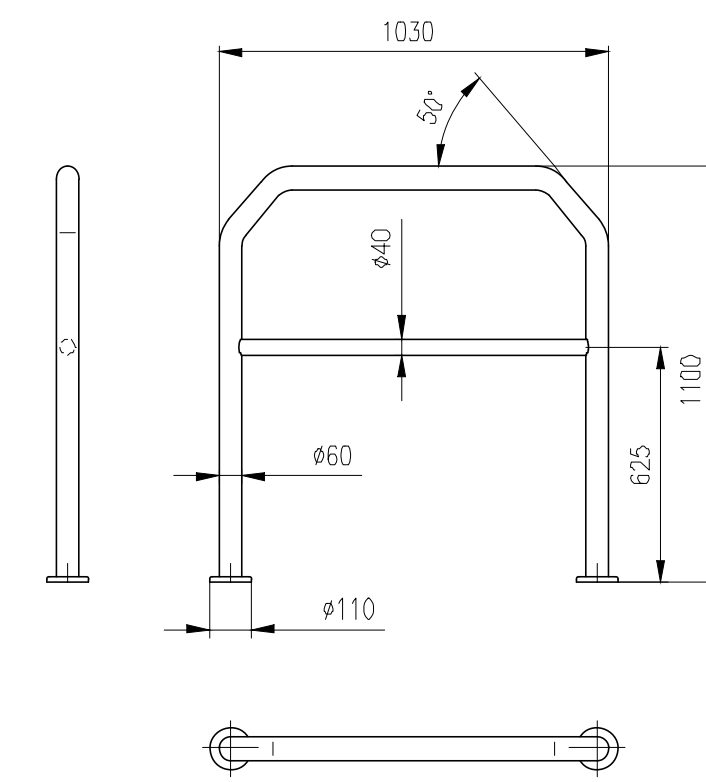

Barrier ZST-1270x1100 for well-directed gateway through the turnstile BAR-ST-DUO

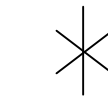
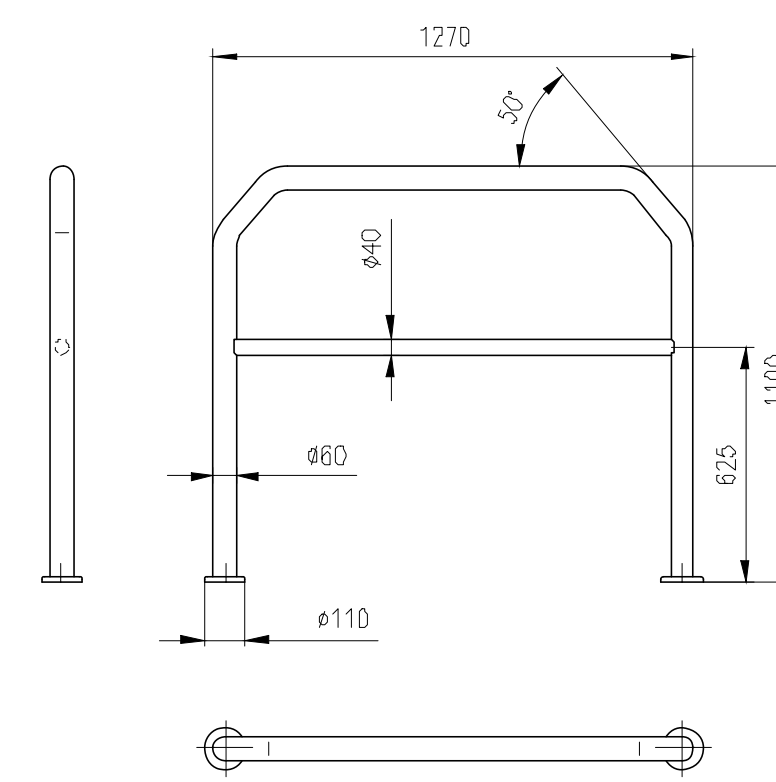

Barrier: ZST-2000x1100

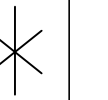
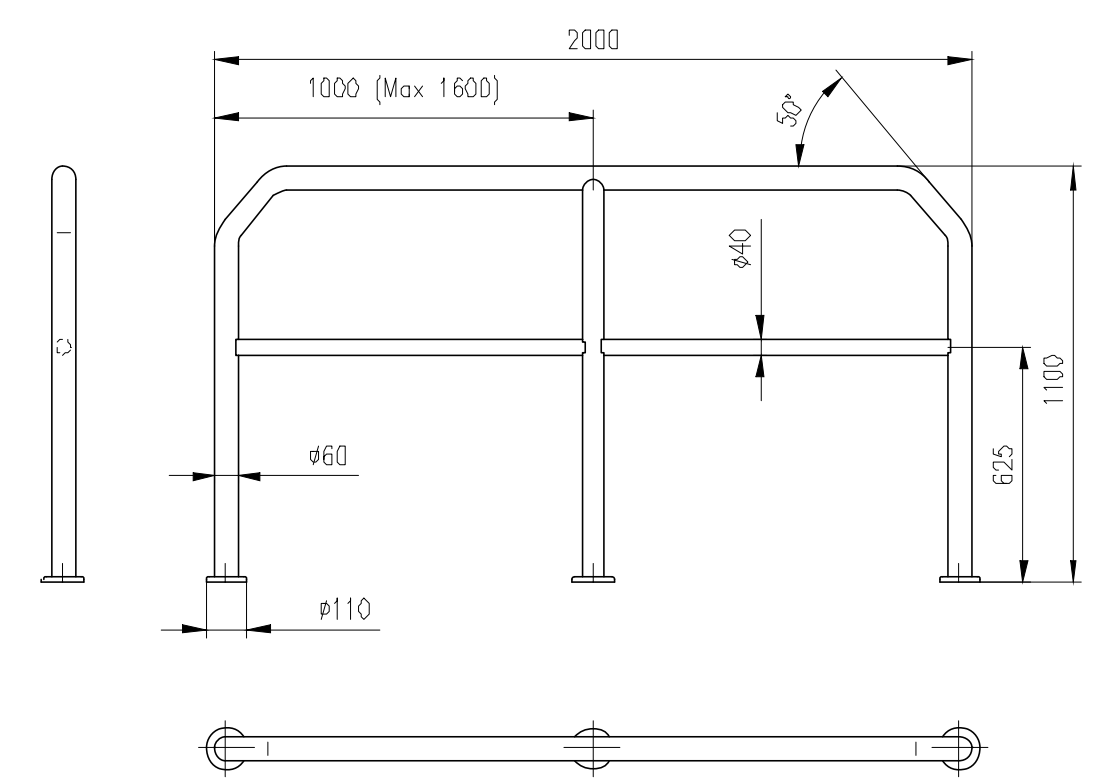

Barrier: ZST-1000+500x1100

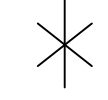
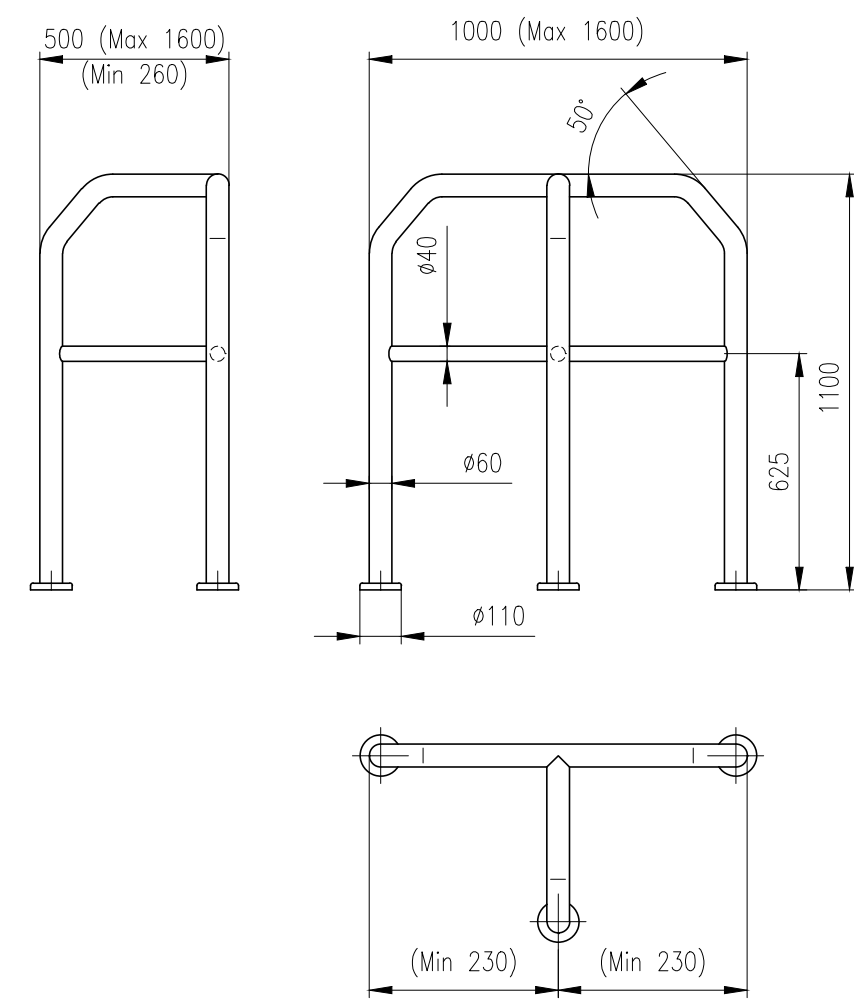

Barrier: ZST-1000+500x1100
Side part of barrier without slant

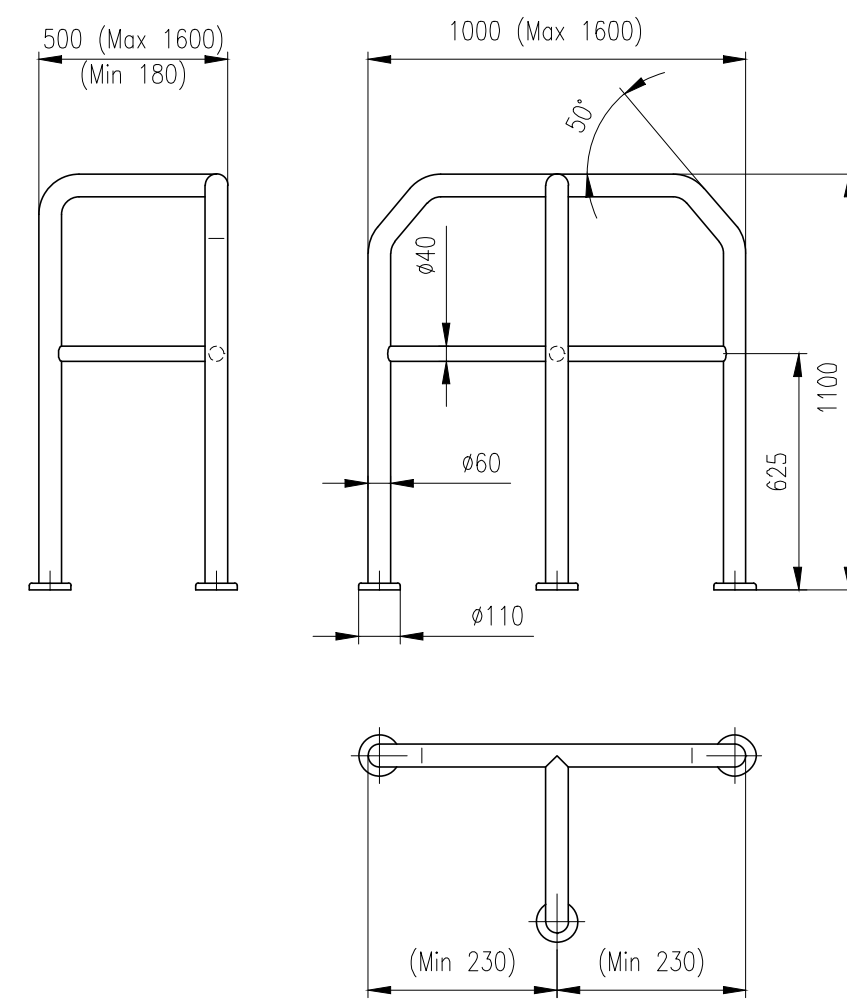

Barrier: ZST-1000x1100
Slant only on one side

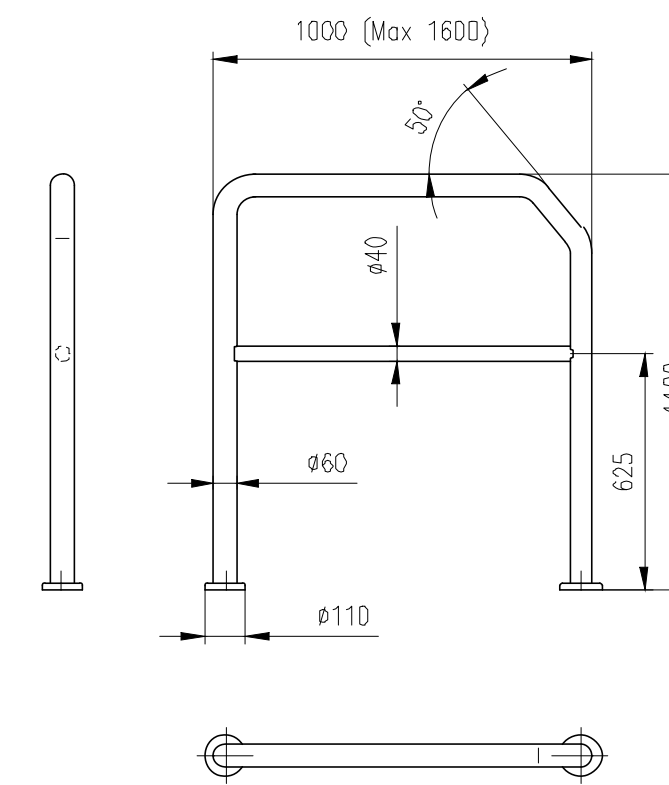

Barrier: ZSTT-1000x1100

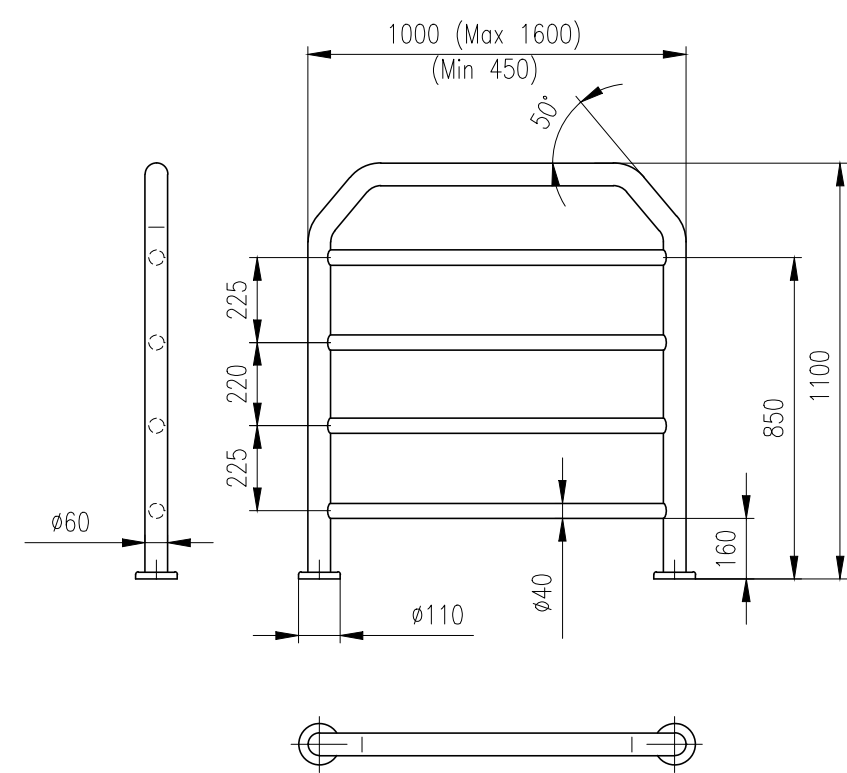

Barrier: ZSTS-P-1000x1100
Infill glass panel: Connex 8,4mm

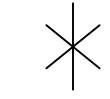
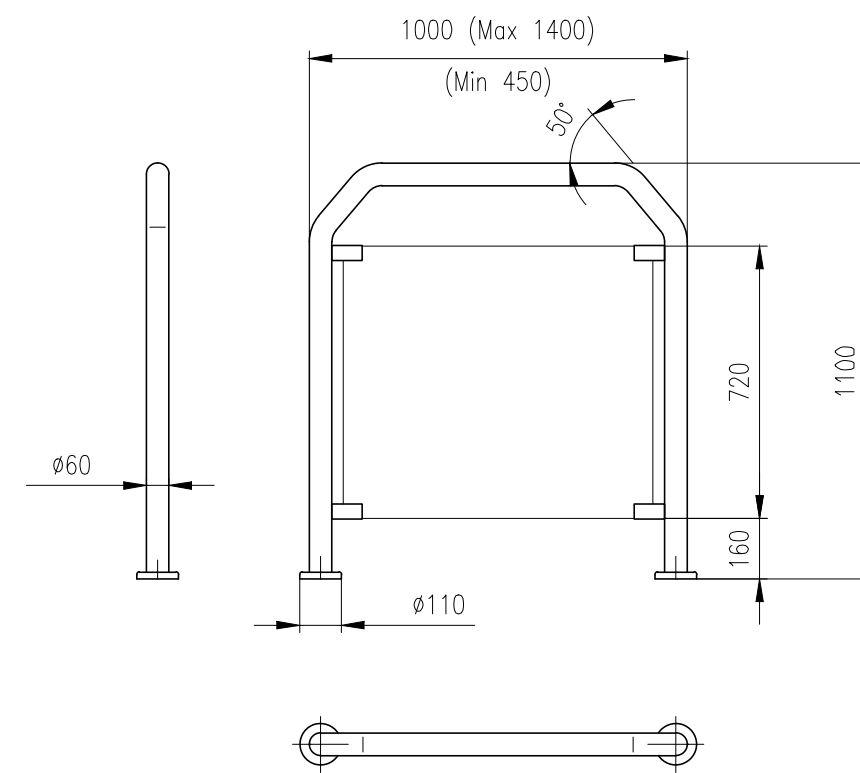

Barrier: ZSTS-1000x1100
Infill glass panel: Connex 8,4mm

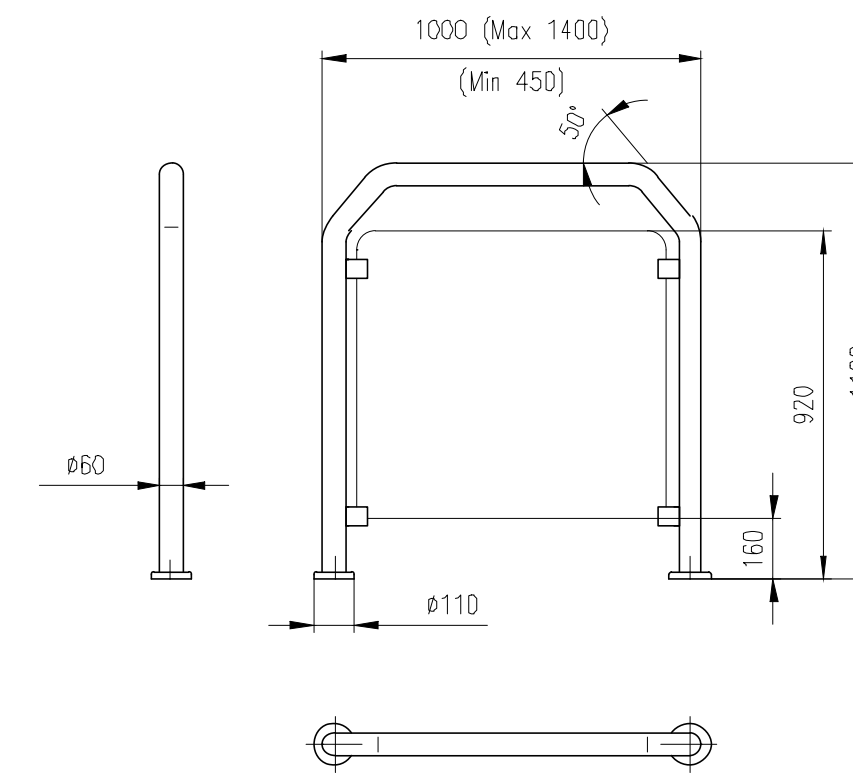

Barrier: ZSTS-T-1000x1100
Infill glass panel: Connex 6,4mm

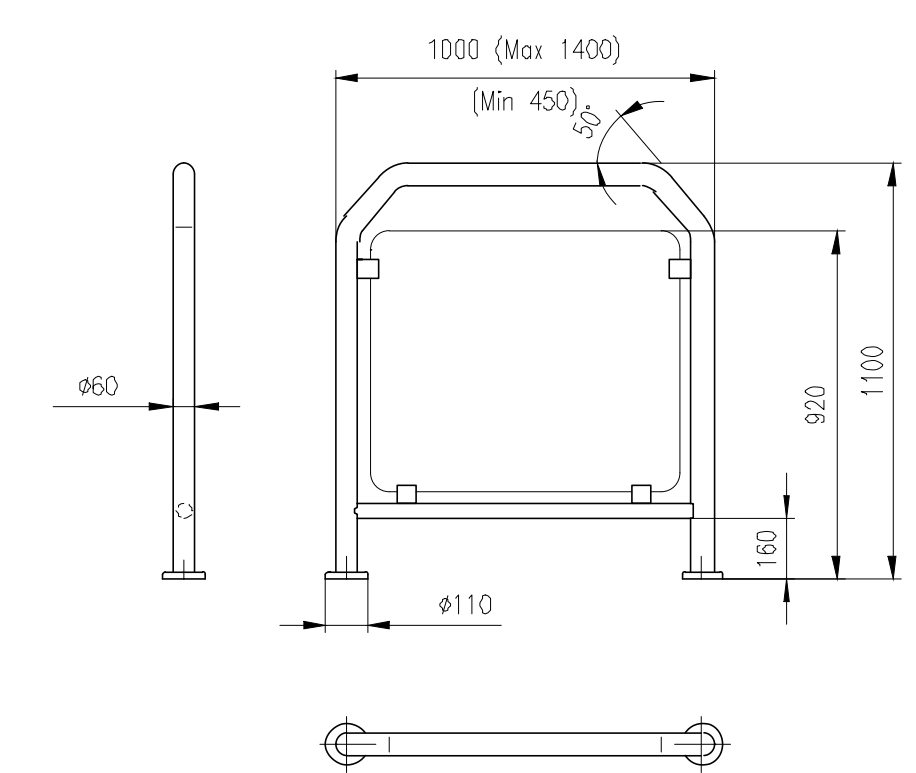

Barrier $\phi 60$ type ZBU, for installation together with turnstile ROUND-J,E,F

Barrier: ZBU-1000x1100

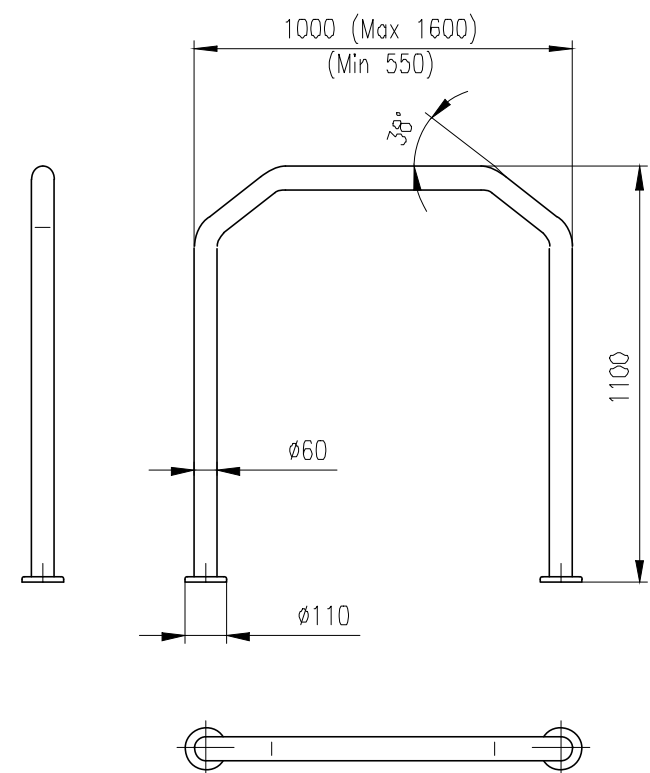

Barrier: ZBBU-1000x1100

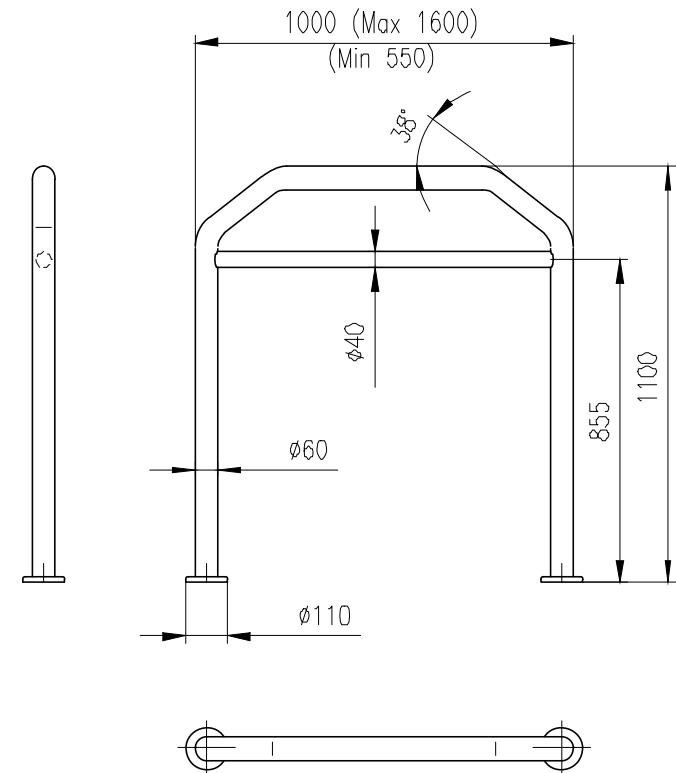

Barrier: ZBBU-2000x1100

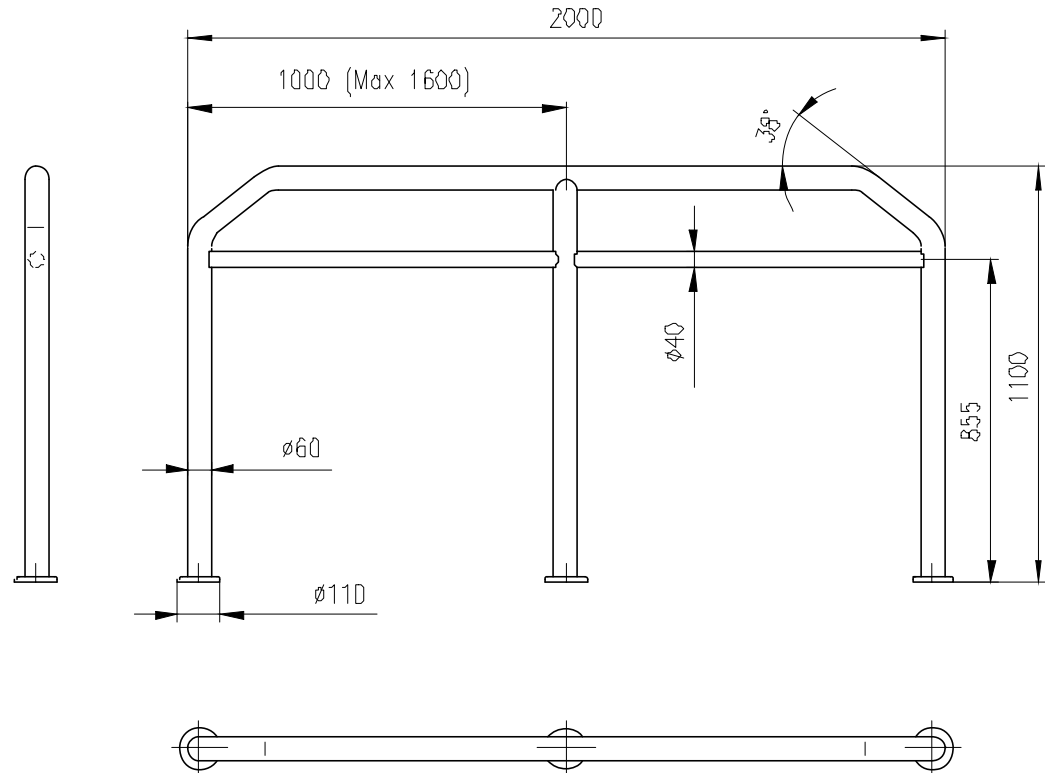

Barrier: ZBBU-1000+500x1100

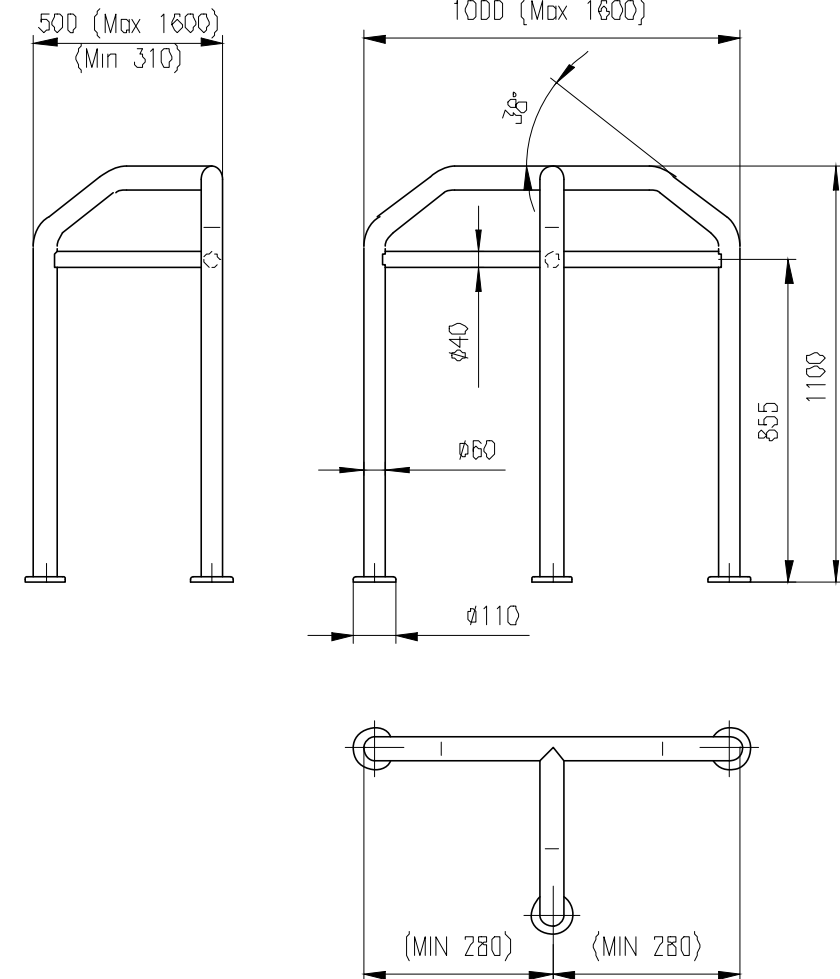

Barrier: ZBTU-1000x1100

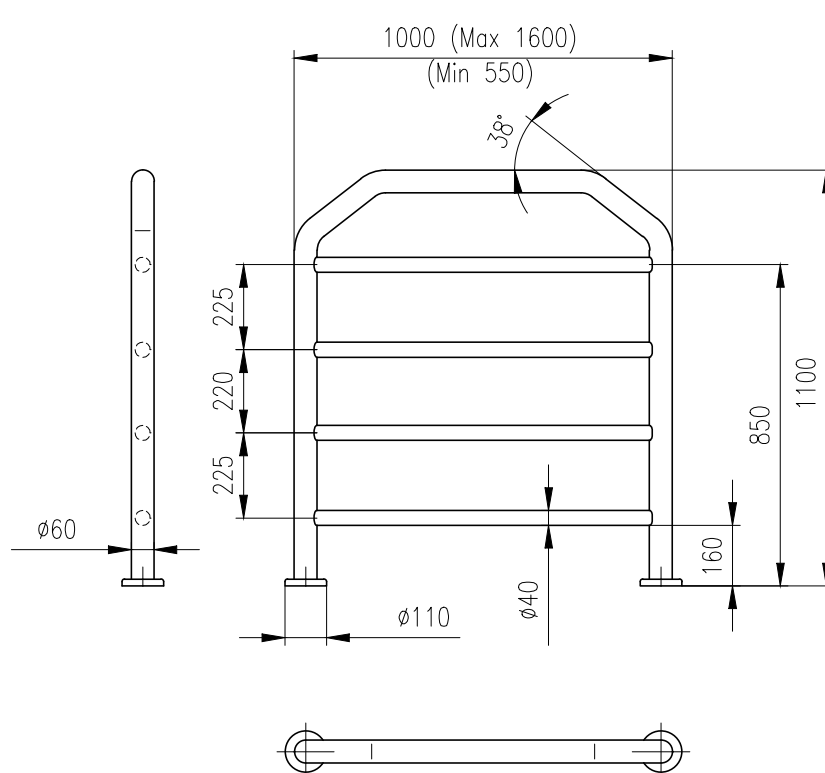

Barrier: ZBSU-P-1000x1100
Infill glass panel: Connex 6,4mm

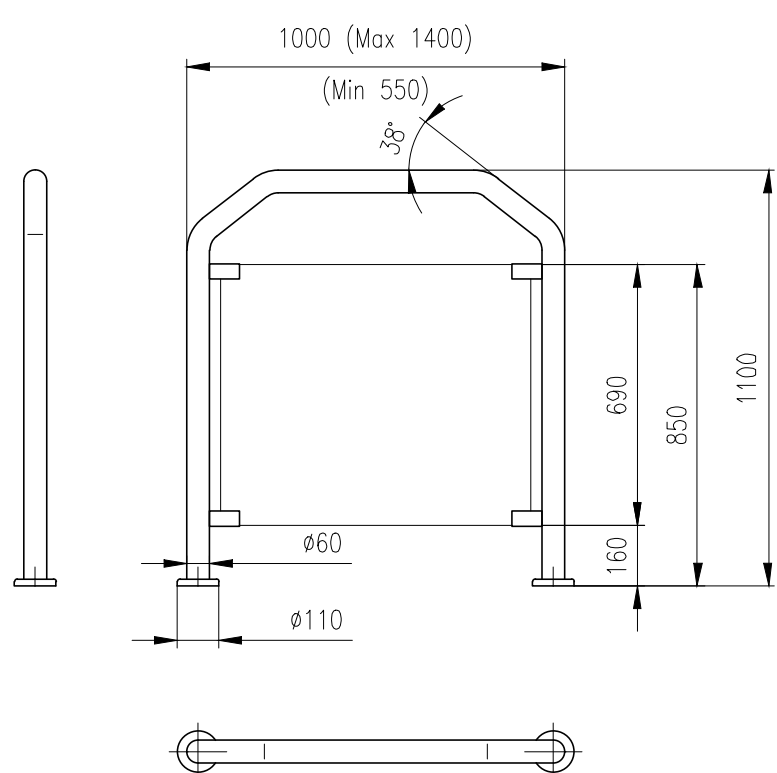

Barrier: ZBSU-1000x1100
Infill glass panel: Connex 6,4mm

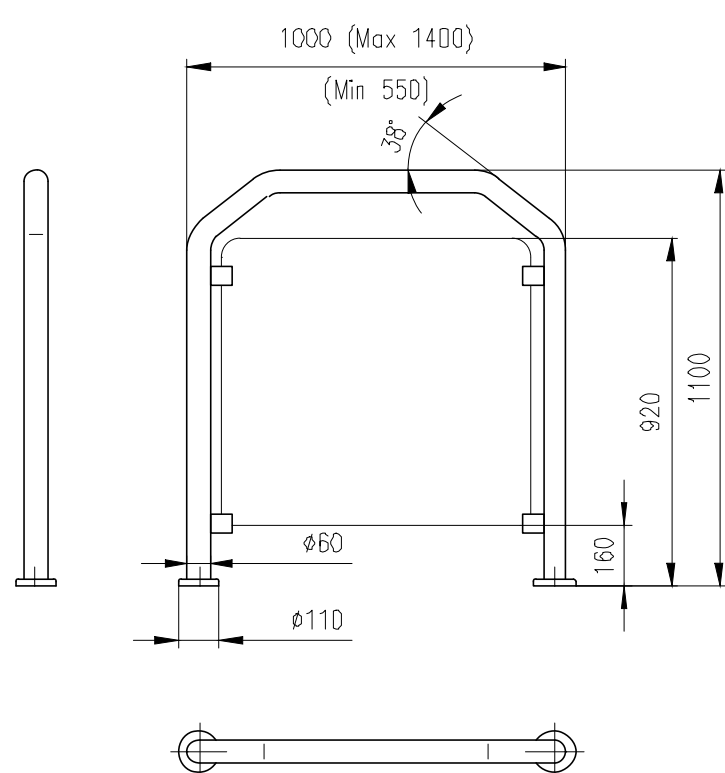

Barrier: ZBSU-T-1000x1100
Infill glass panel: Connex 6,4mm

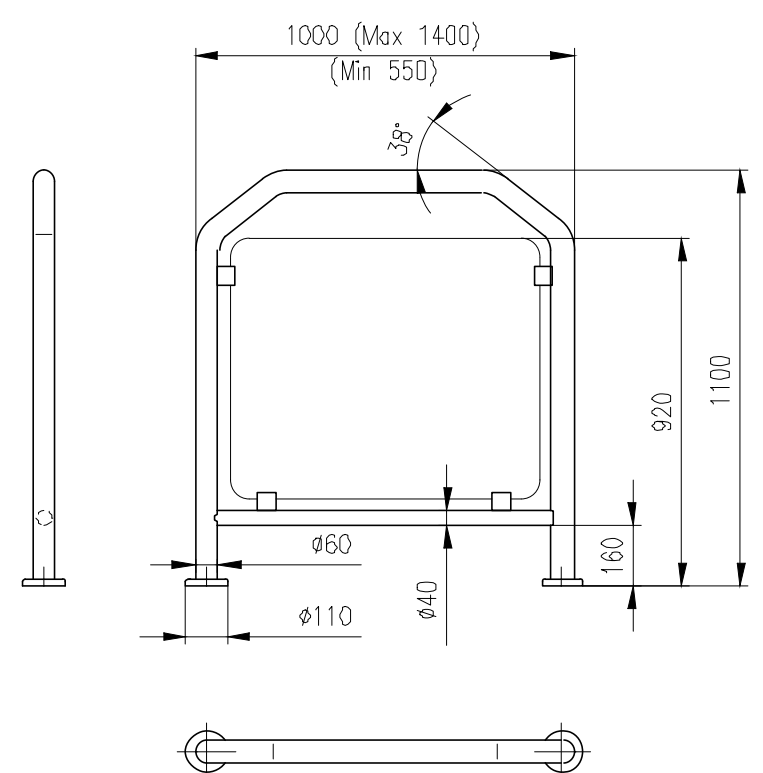

Barrier: J-S-1000x1100
for installation together with turnstile ROUND-J-S

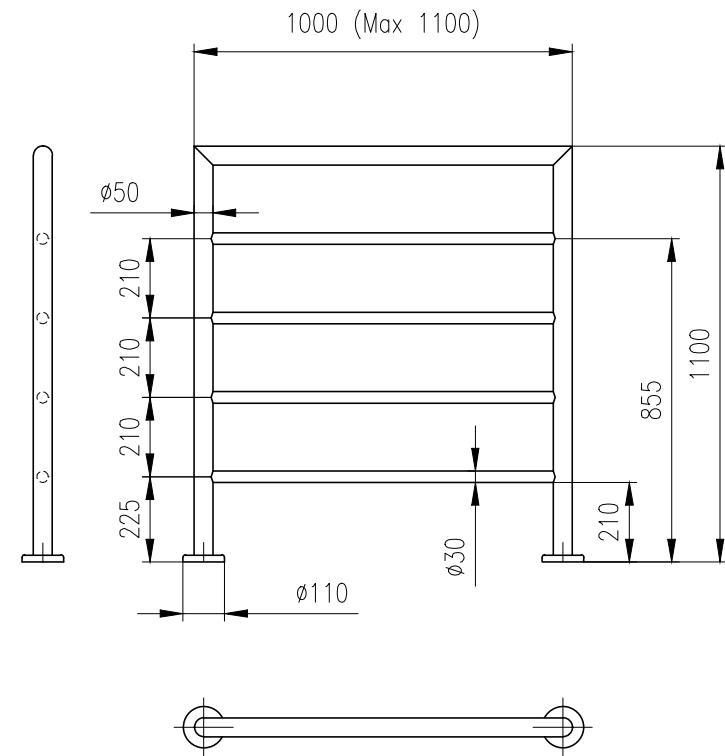

Barrier: J-S-2000x1100
for installation together with turnstile ROUND-J-S

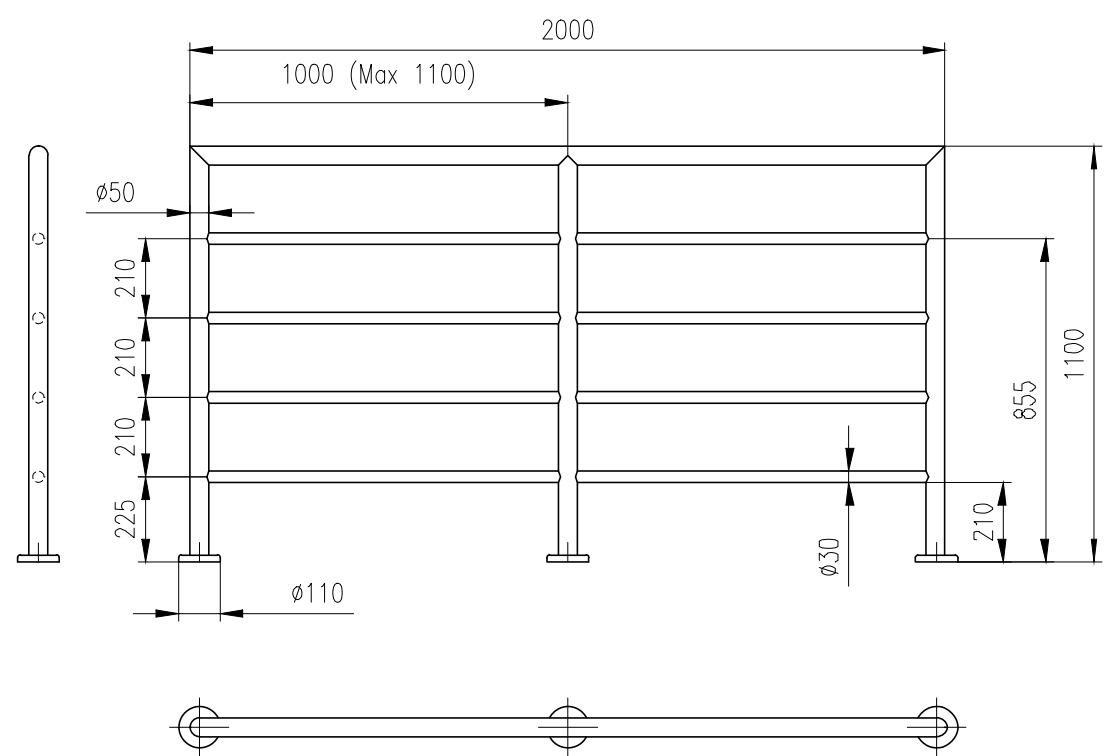

Barriers $\phi 60$ type: ZB

TUEGA

DATE	SCALE	FORMAT
September 2014	1:20	A1

Barrier: ZB-1000x1100

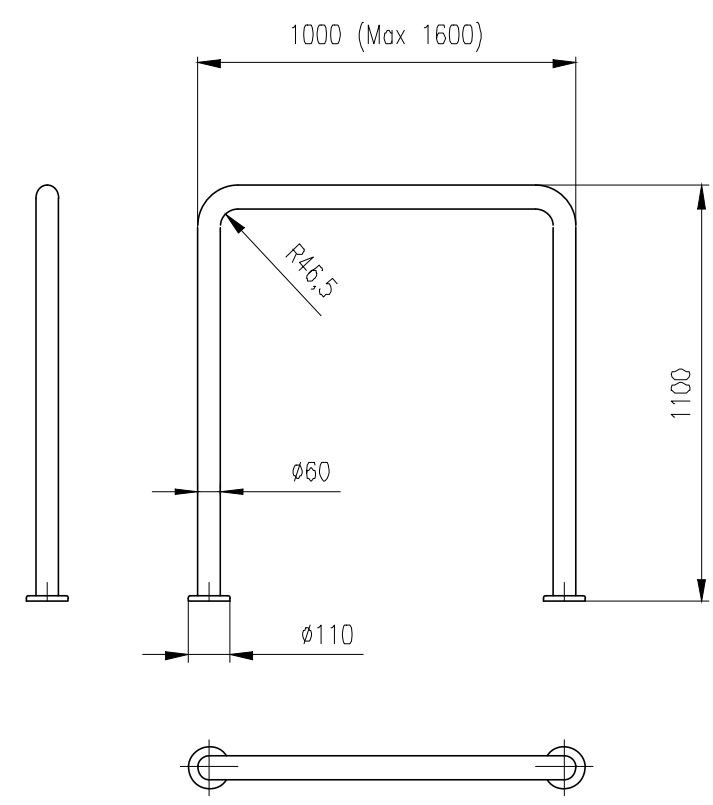

Barrier: ZBB-1000x1100

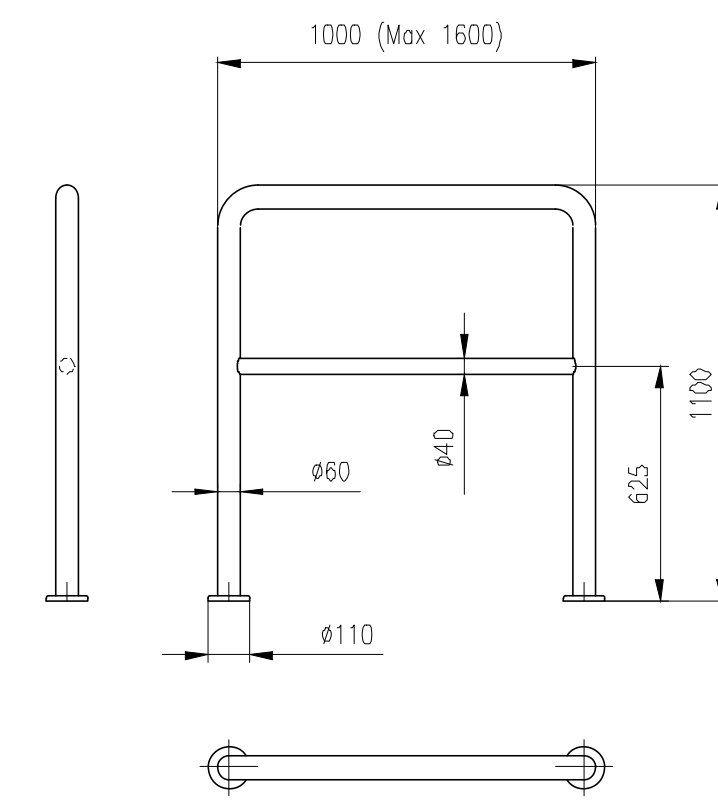

Barrier: ZBB-2000x1100

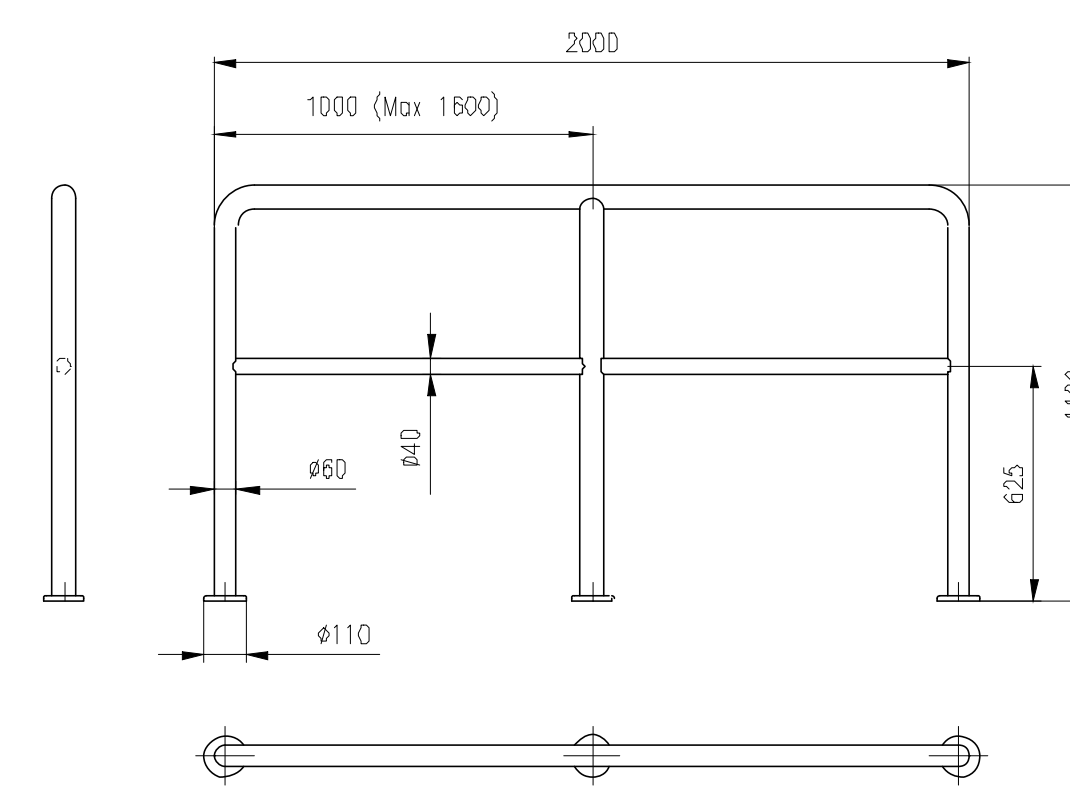

Barrier: ZBB-1000+500x1100

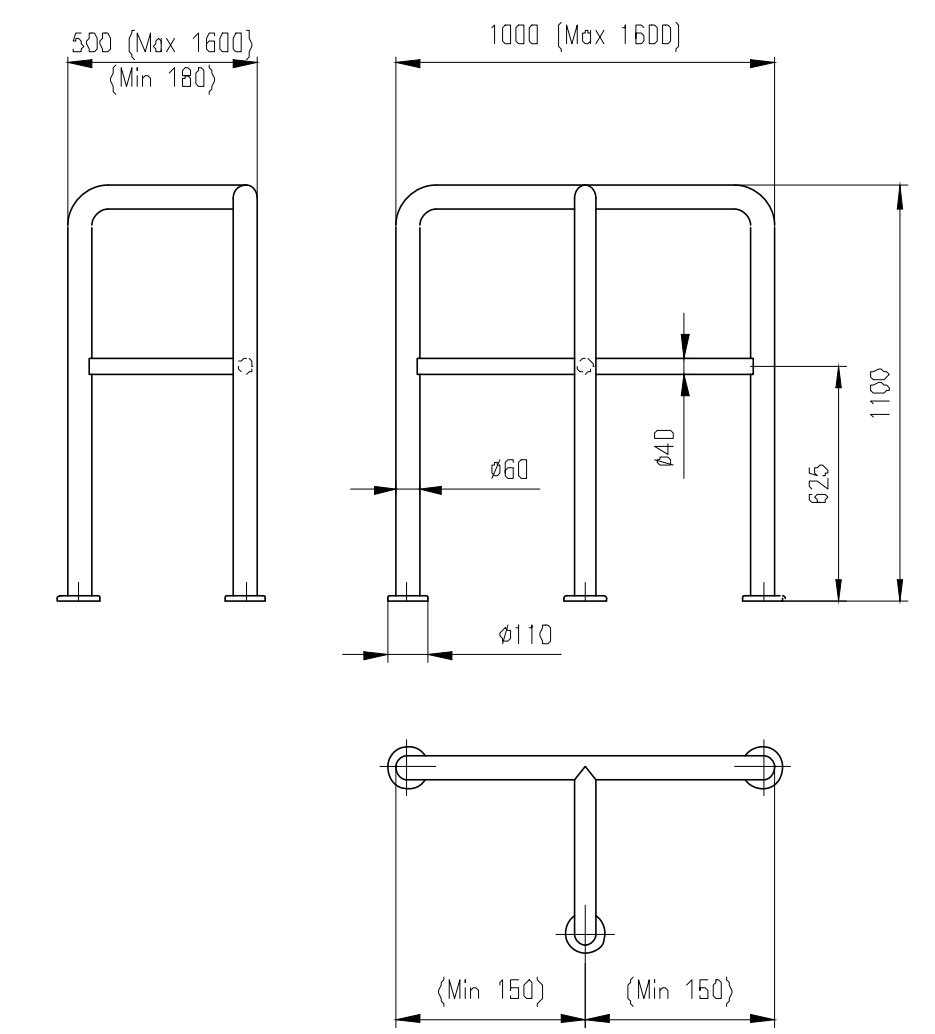

Barrier: ZBT-1000x1100

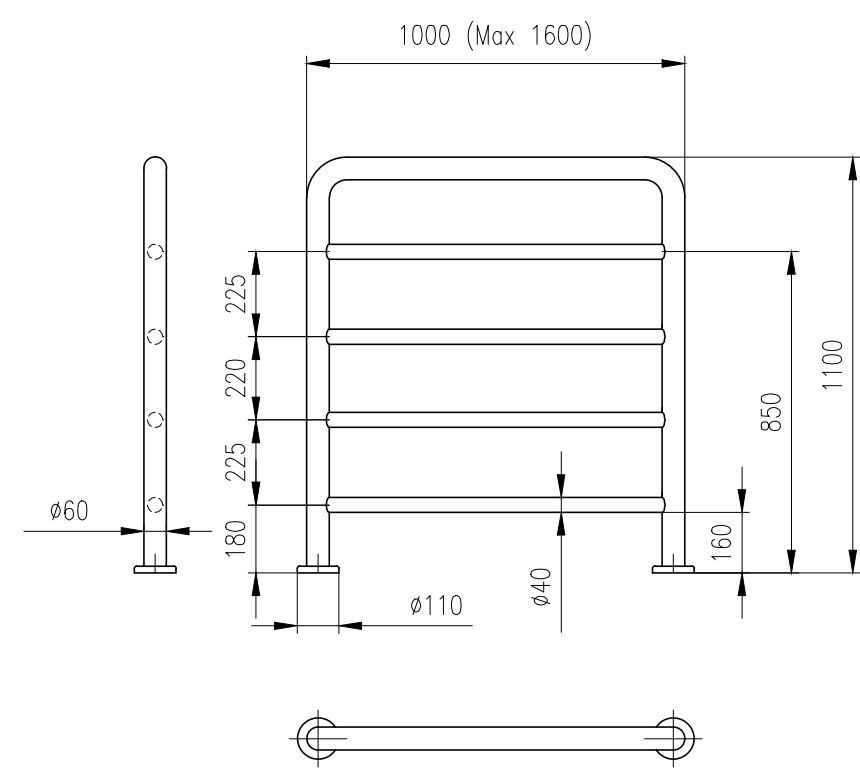

Barrier: ZBS-P-1000x1100
Infill glass panel: Connex 8,4mm

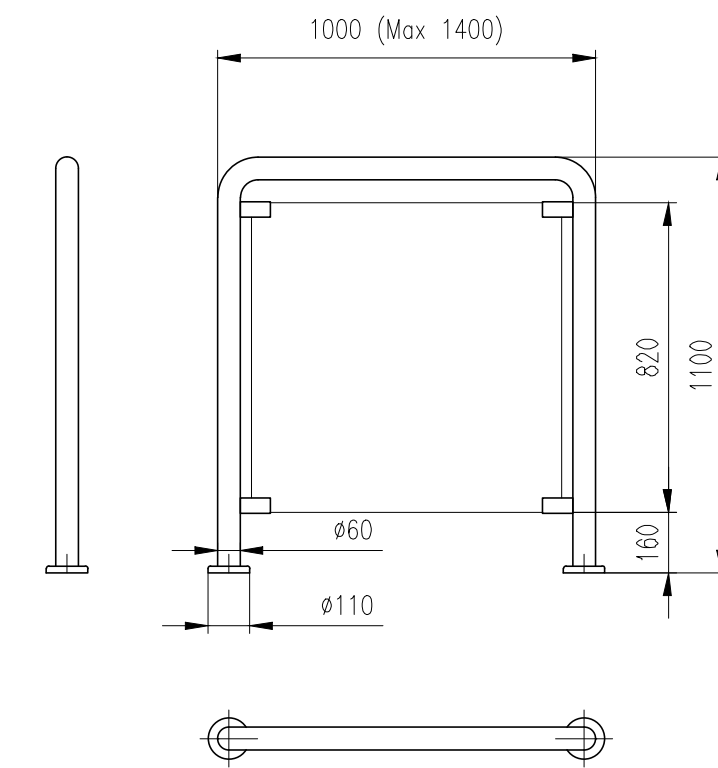

Barrier: ZBS-1000x1100
Infill glass panel: Connex 6,4mm

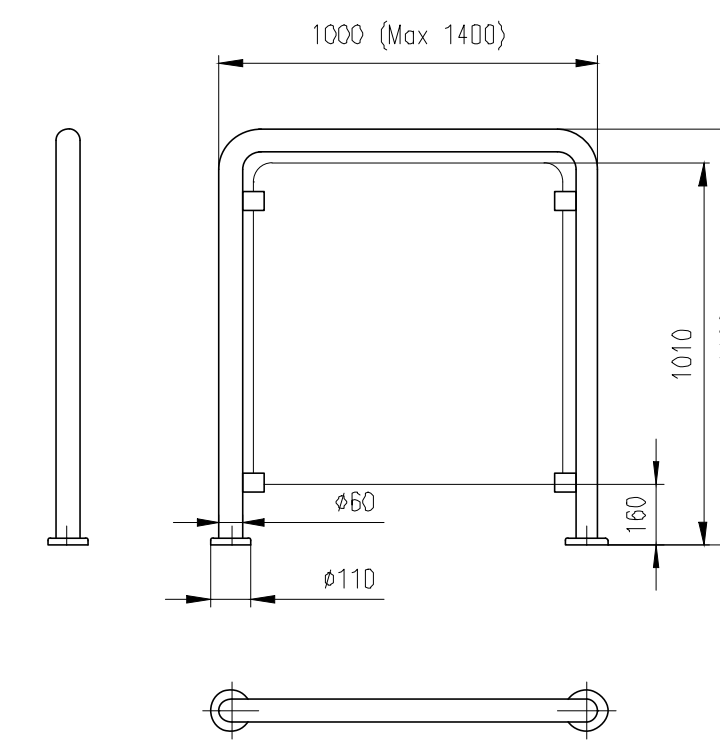

Barrier: ZBS-T-1000x1100
Infill glass panel: Connex 6,4mm

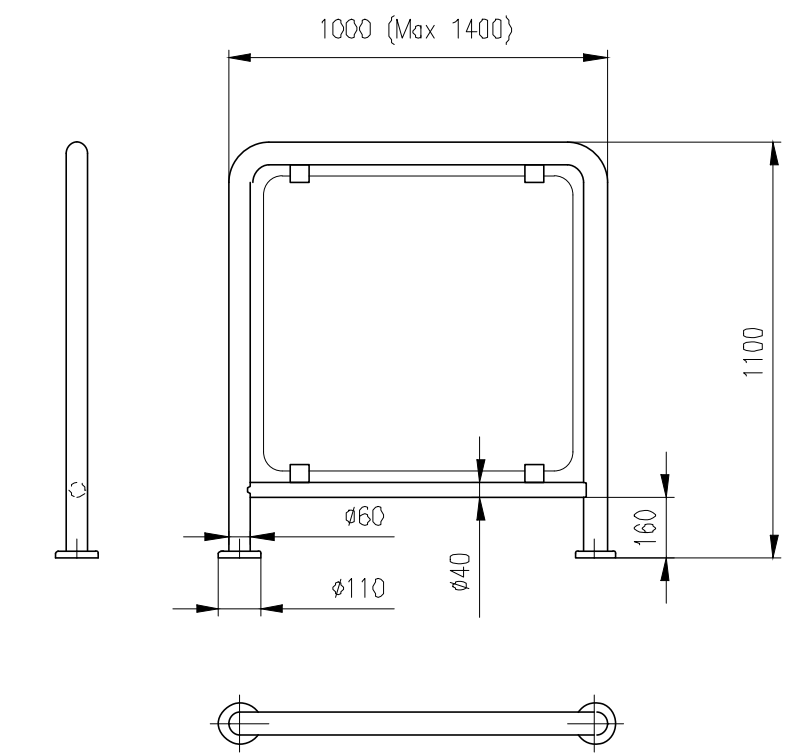

Barrier: ZBB-Bicycle-600x550x1250 + ZB-850x800

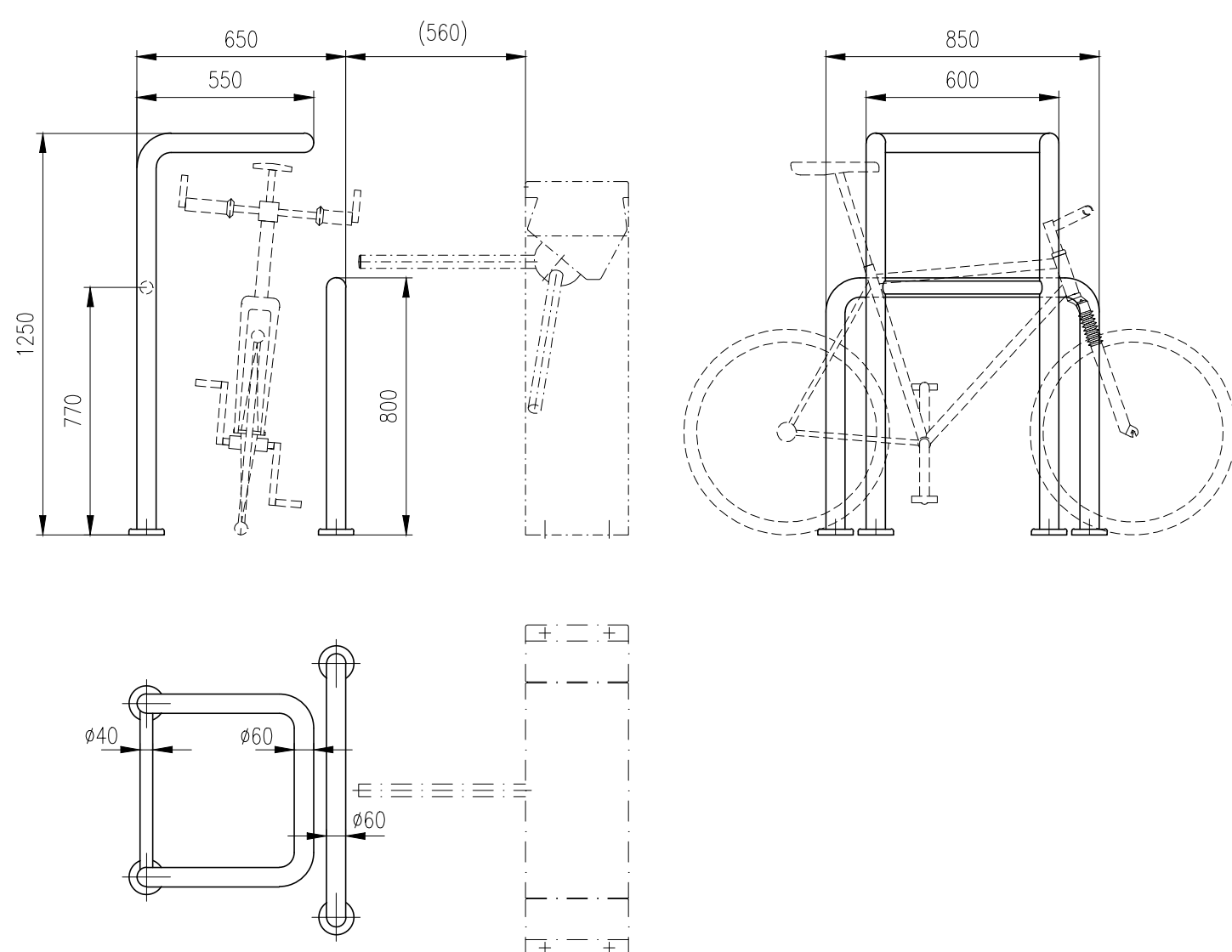

Barrier: ZBB-Bicycle-600x550+200x1250 + ZB-850x800

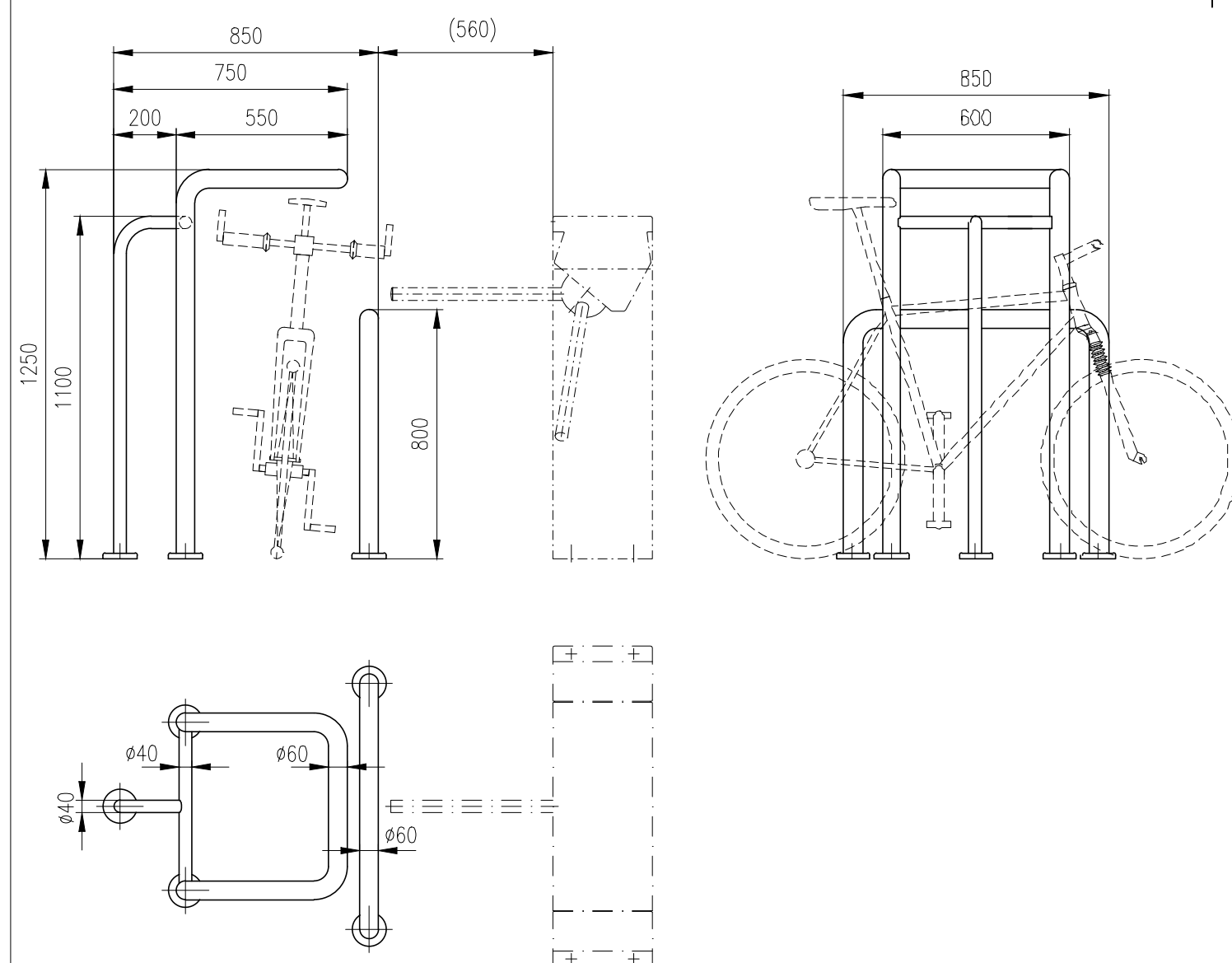

Barrier: ZBB-Bicycle-600x550+150x1250 + ZB-850x800

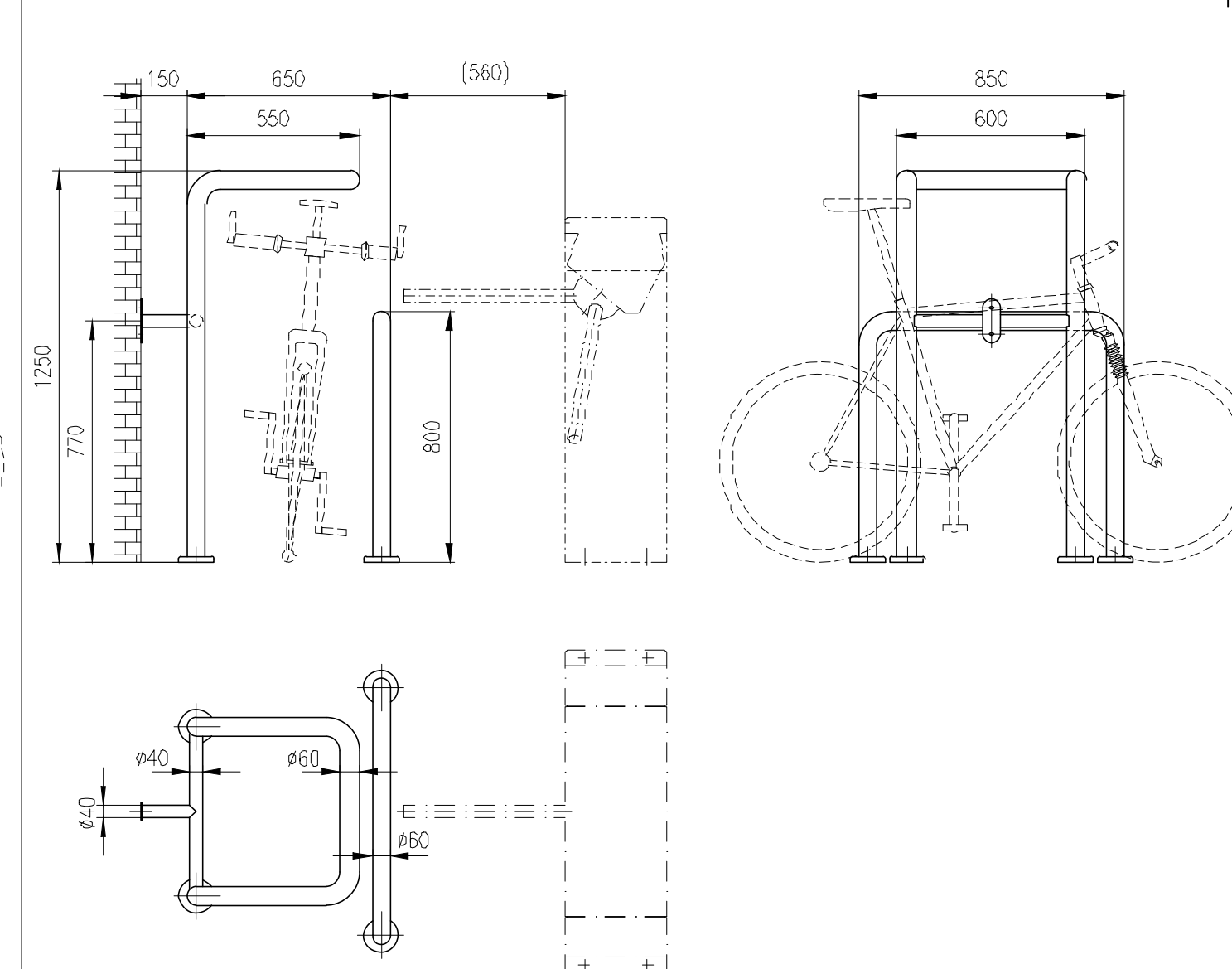

Modification of barriers

<p>Frame of barrier $\varnothing 50$</p>	<p>Frame of barrier $\varnothing 50$ without radius</p>	<p>Frame of barriers $\varnothing 60$ without radius</p>	<p>Frame of barriers $\varnothing 40$ without radius</p>
---	--	---	---

<p>Flange Clampig Device $\varnothing 40$ (Aplication together with barrier ZCS is not possible)</p>	<p>Flange Clampig Device $\varnothing 60$ (Aplication together with barriers ZS,ZSTS,ZBS,ZBSU is not possible)</p>
---	---

<p>Standard</p>	<p>Lock</p>	<p>Standard</p>	<p>Lock</p>		
-----------------	-------------	-----------------	-------------	--	--

Posts

TUEGA

DATE	SCALE	FORMAT
September 2014	1:20	A1

Post: NCR-60x990
(RFID holder)

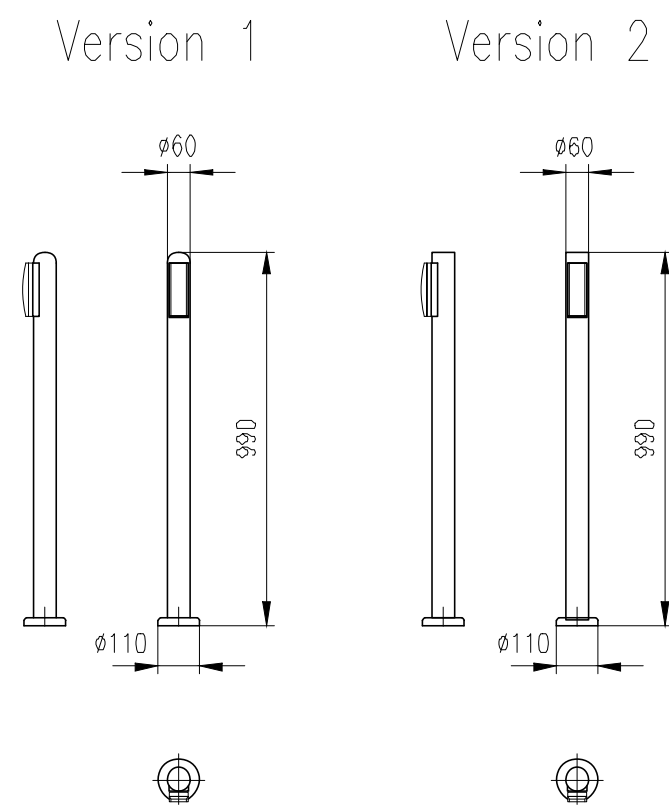

Post: NCR-60x990-30°
(RFID holder)

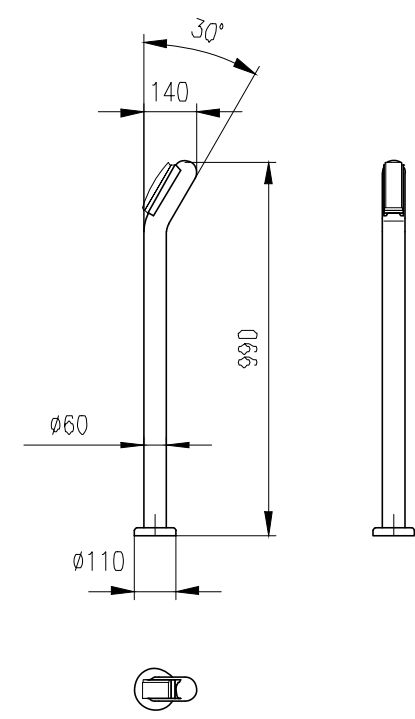

Post: NCR-213x990-30°
(REA::TOUCH holder)

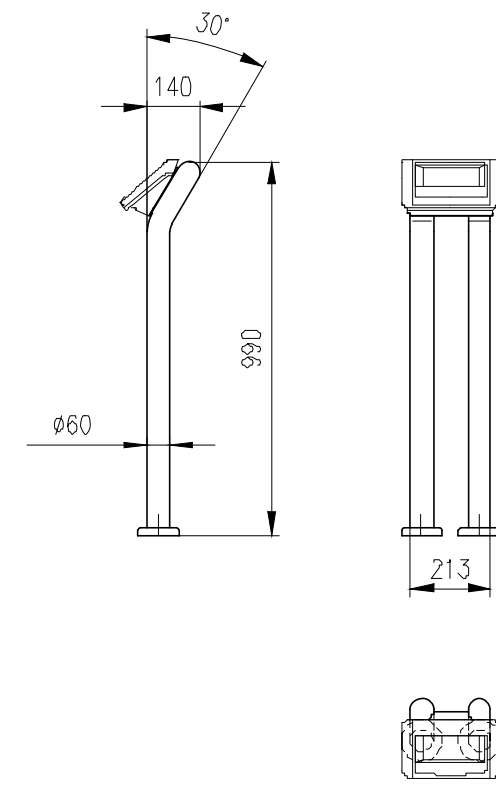

Post: NCR-60x990-45°
(RFID holder)

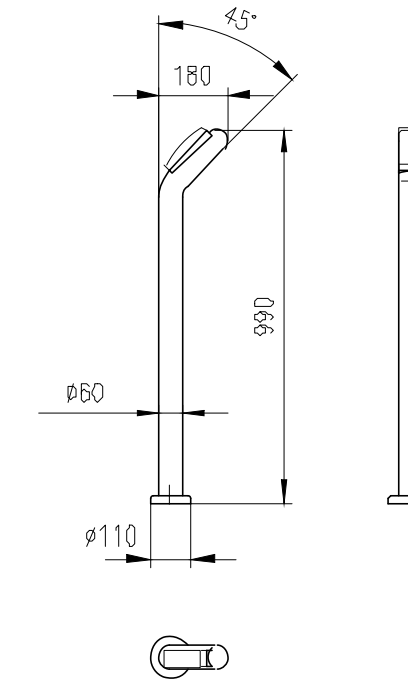

Post: NCR-213x990-45°
(REI::ST holder)

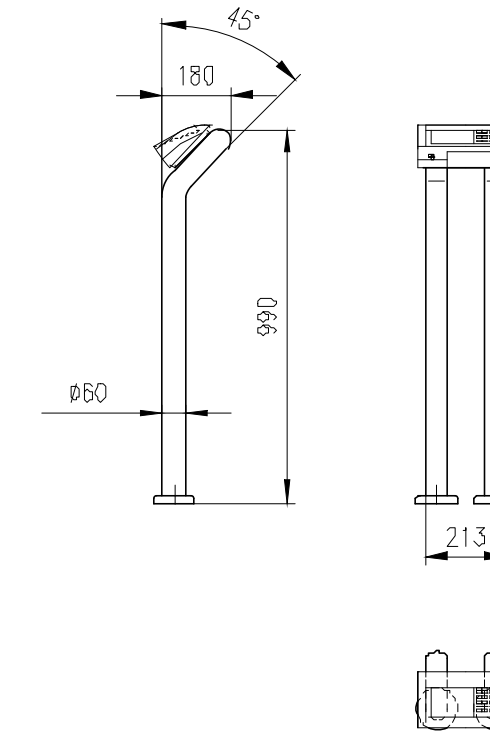

Post: N-60x1100

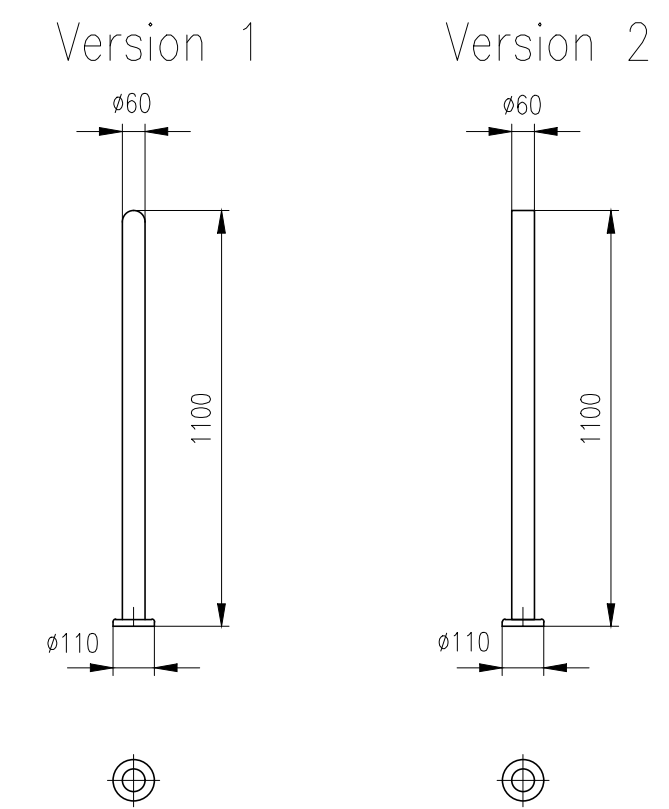

Post: N-213x1100

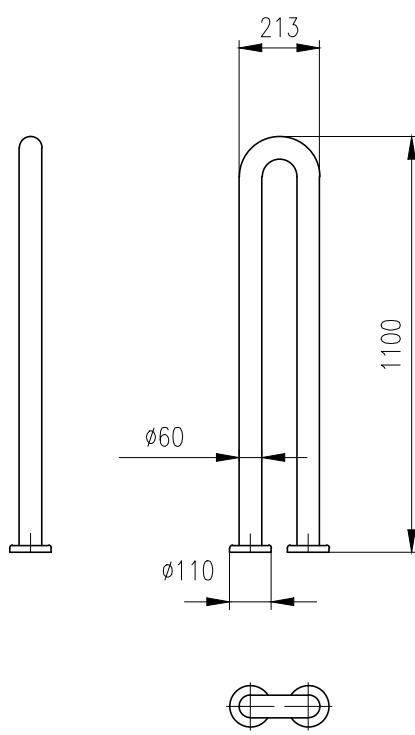

Barrier: ZC-240x1020

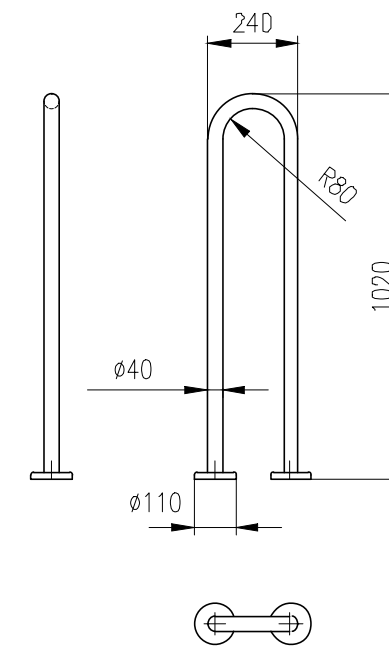

Post: TOWER 168x1060

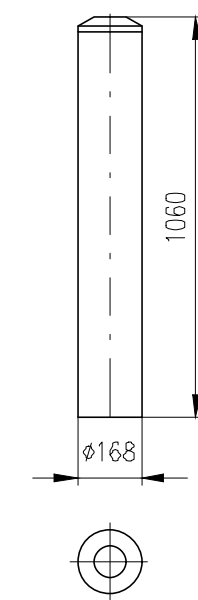

Post: TOWER 204x1060

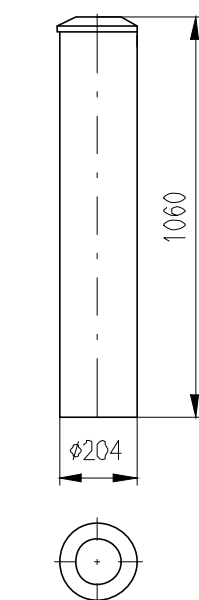

Post: TOWER (REA::TOUCH holder)

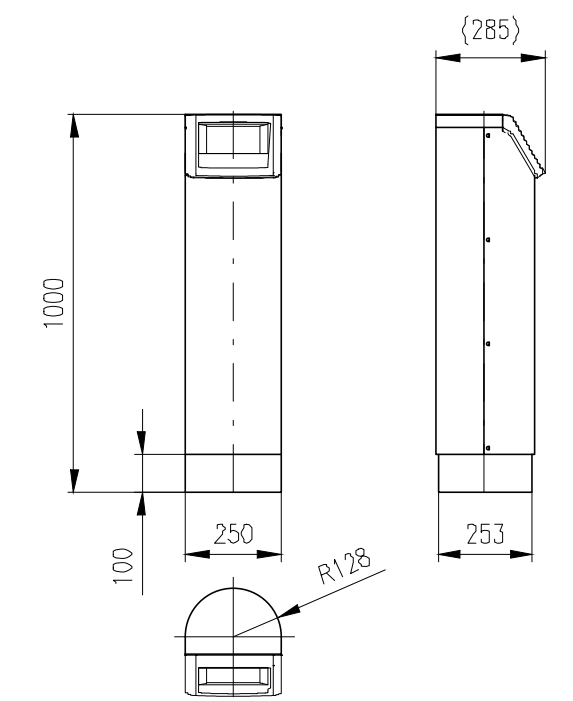

Post: TOWER 76x990
(push button)

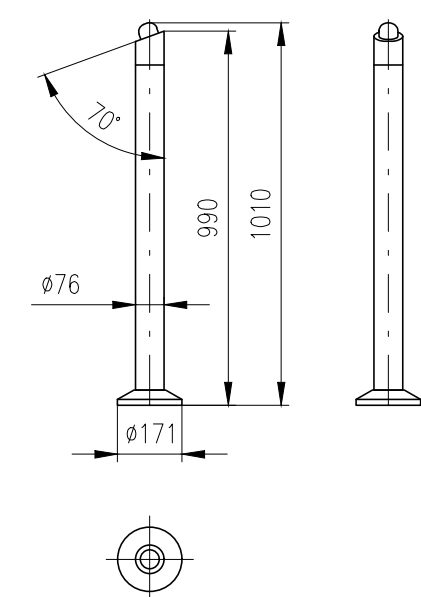

Post: TOWER 76x1000
(REA::TICKET holder)

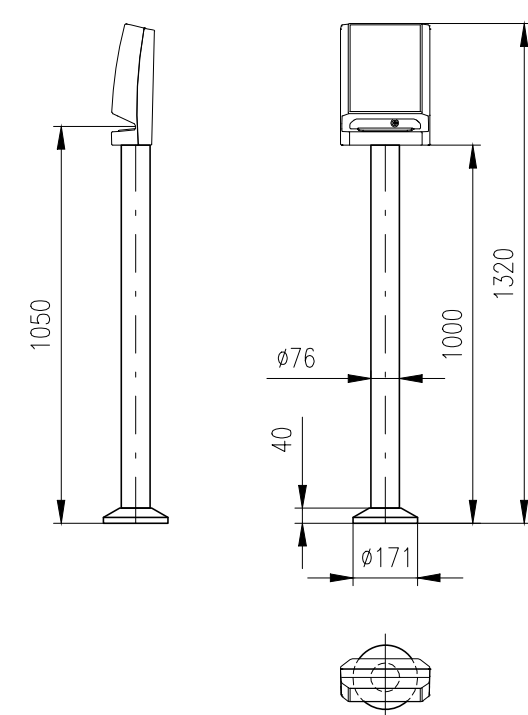

Post: TOWER-EXI (Front access)

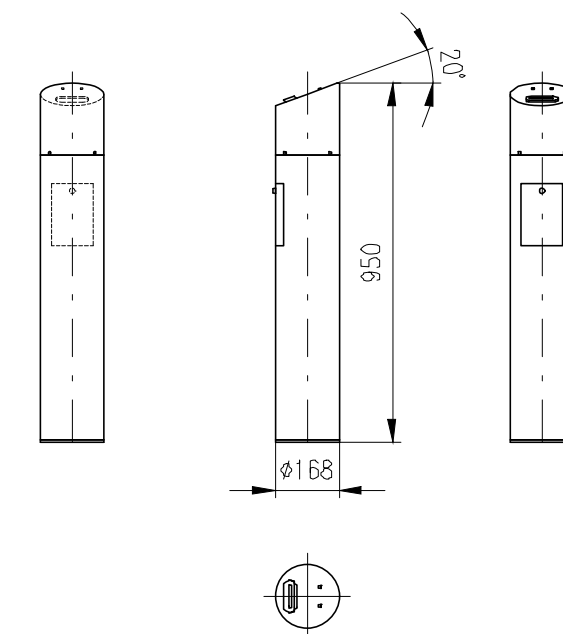

Post: TOWER-EXI (behind access)

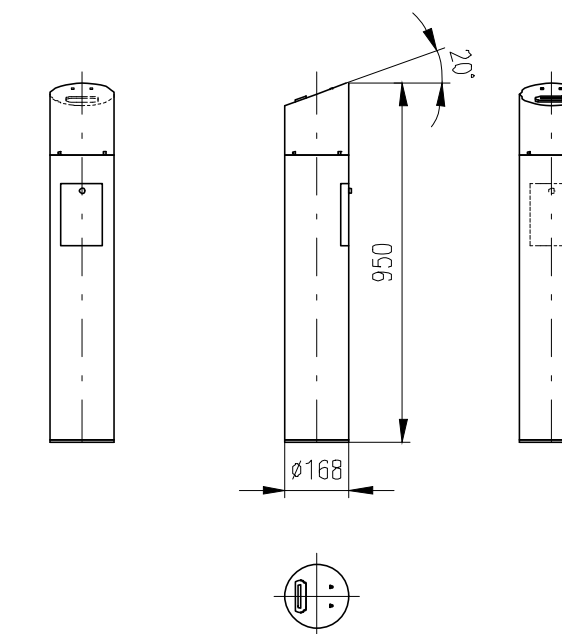

Post: Universal terminal housing

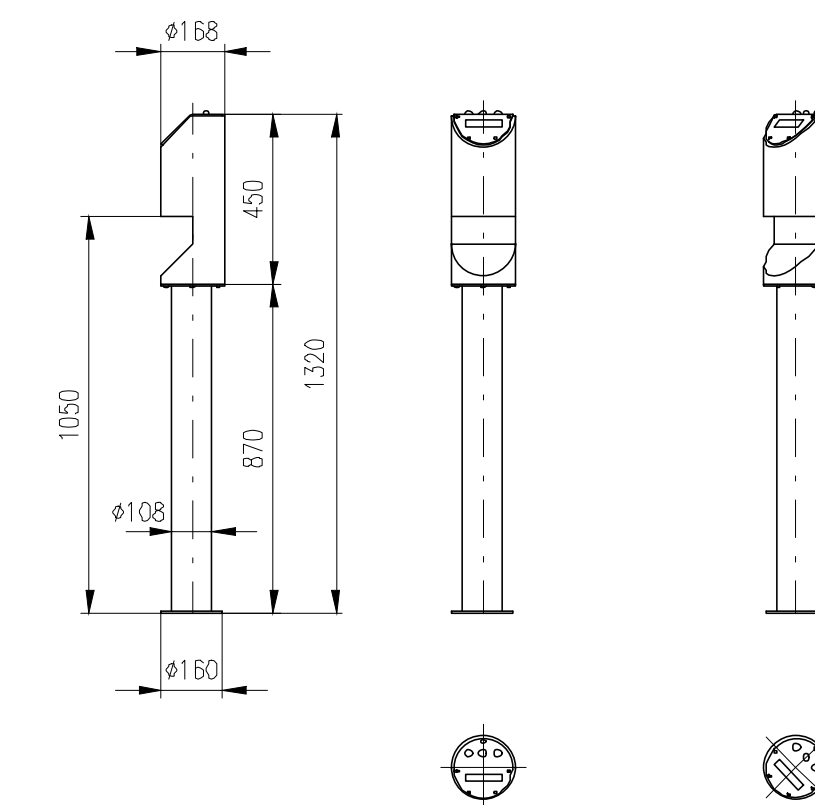

Post: Universal terminal housing

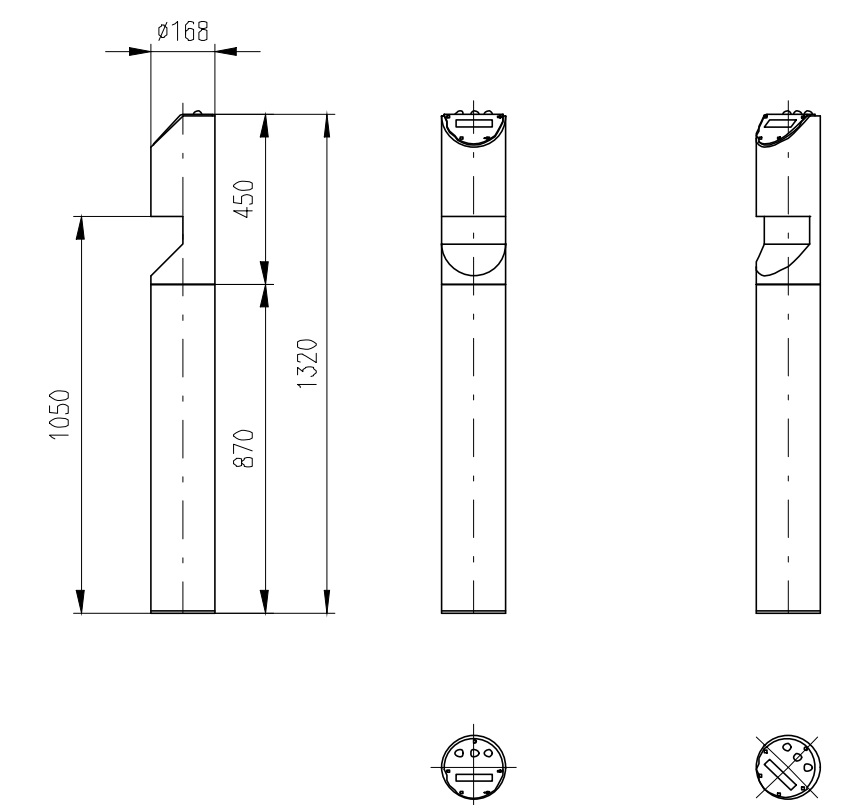

Posts

Post: SG
Slant – RFID head holder

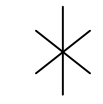
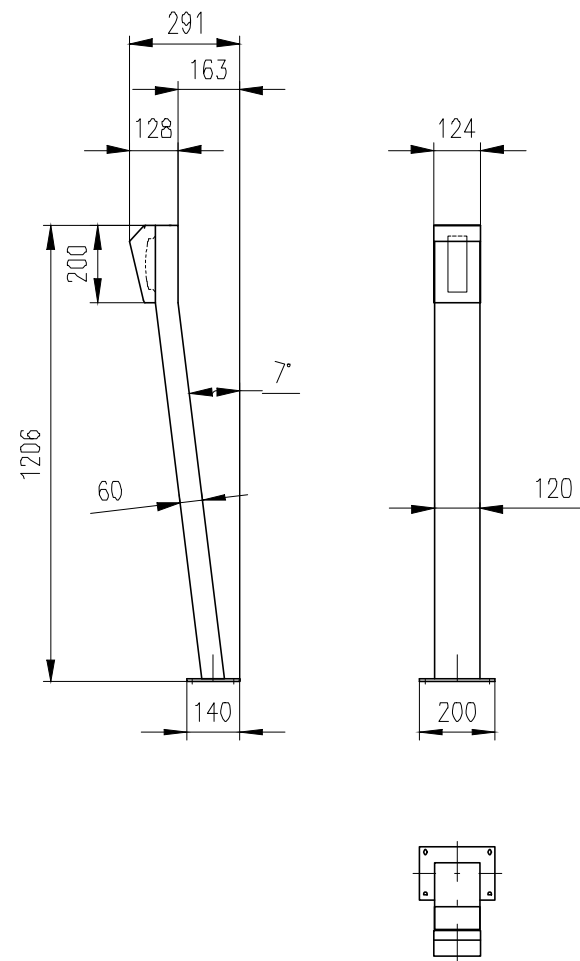

Post: RP
Slant – REA::TOUCH holder

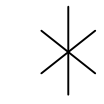
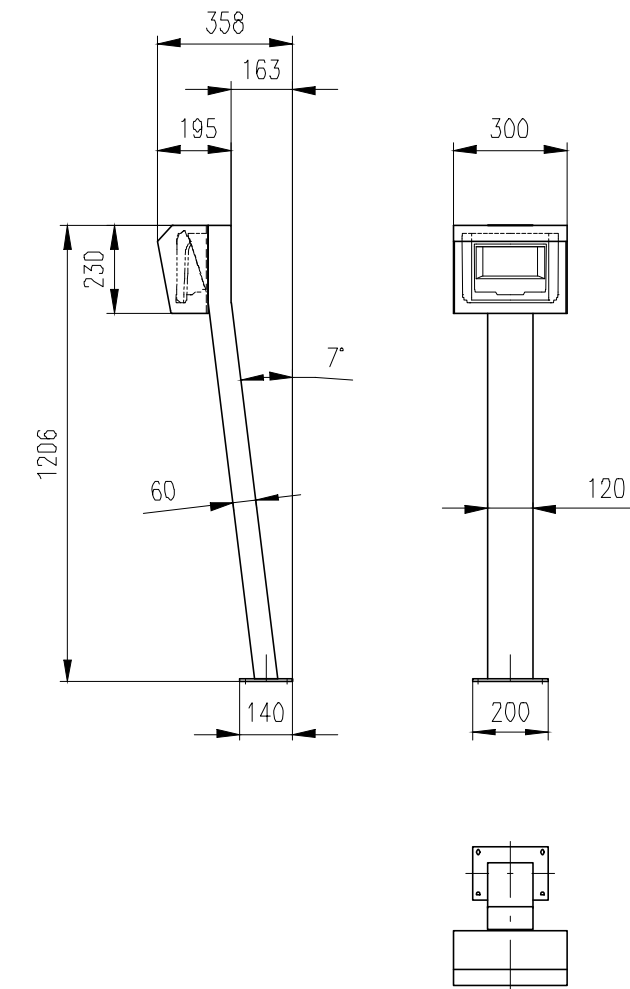

Post: HELIOS
Slant – Intercom holder

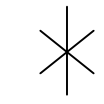
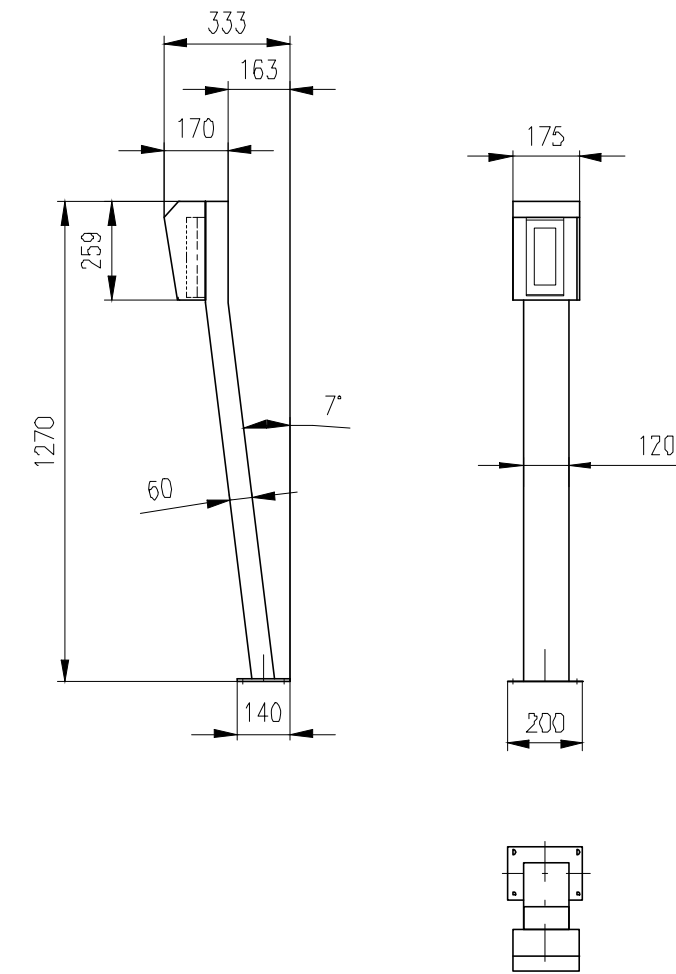

Post: HELIOS
Slant – Intercom and
RFID head holder

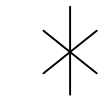
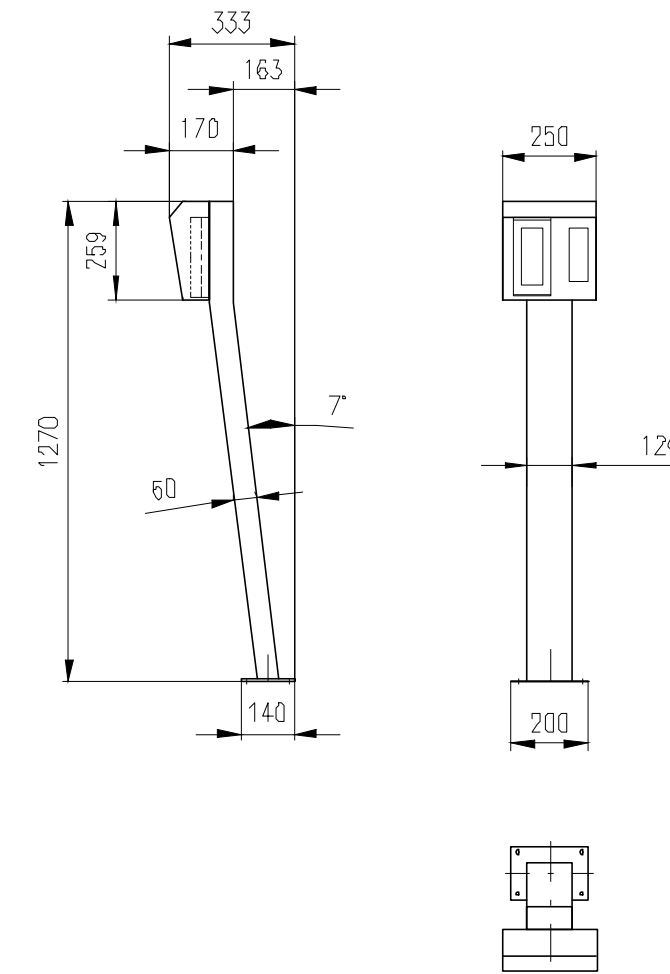

Post: EXI 2

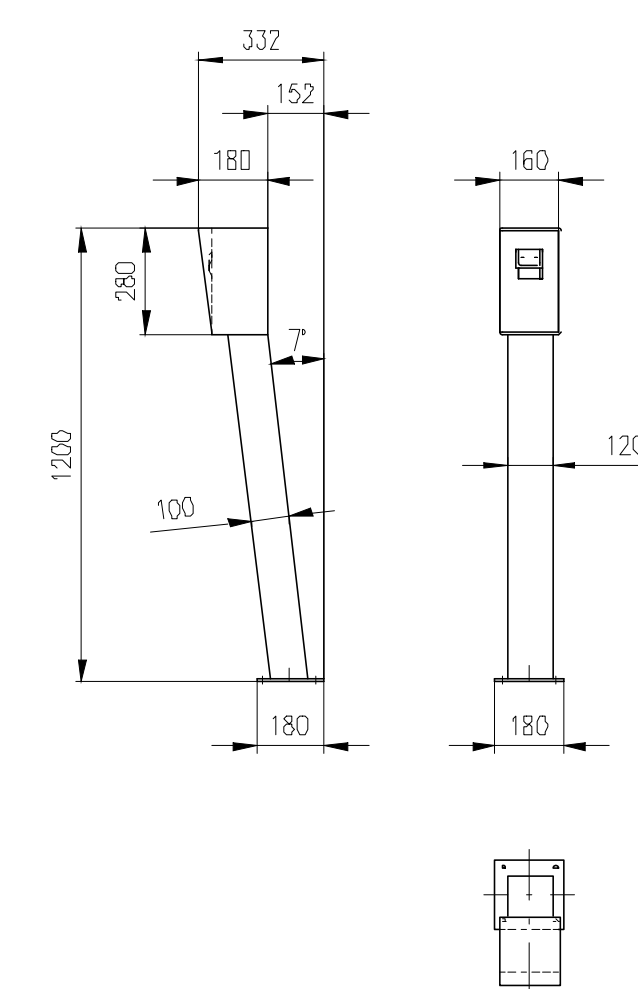

Post: SG
Straight – RFID head holder

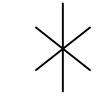
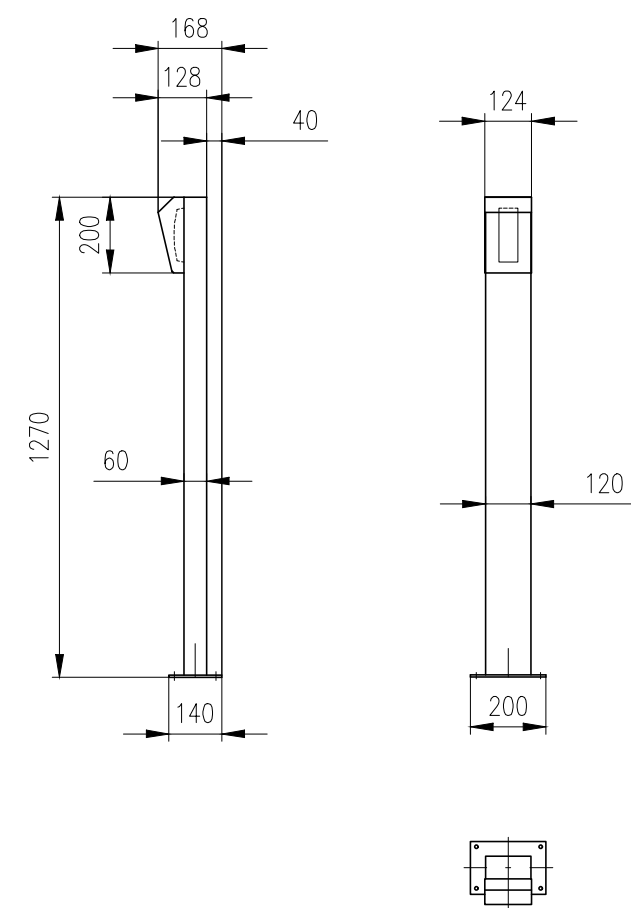

Post: RP
Straight – REA::TOUCH holder

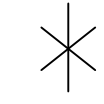
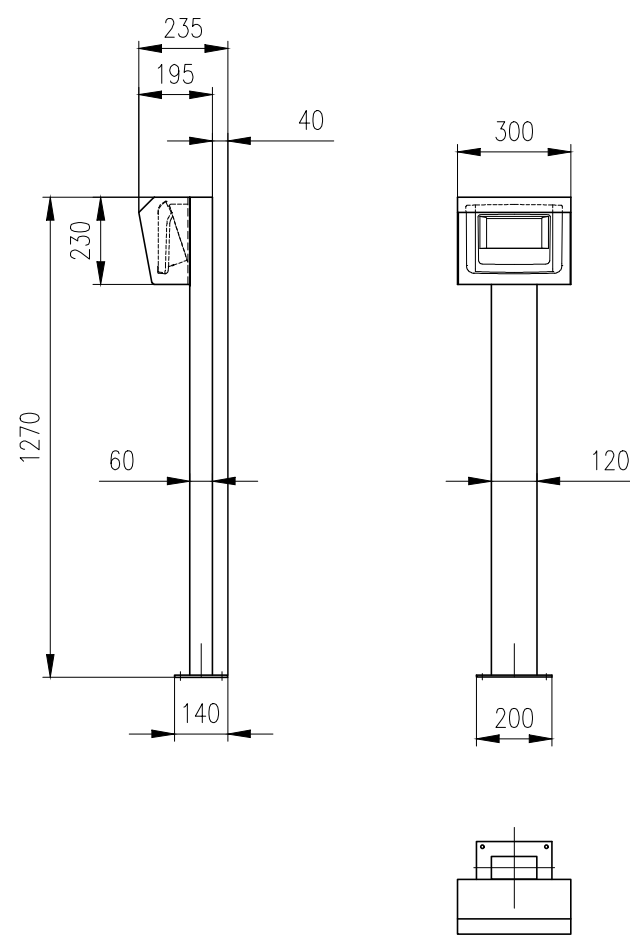

Post: HELIOS
Straight – Intercom holder

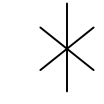
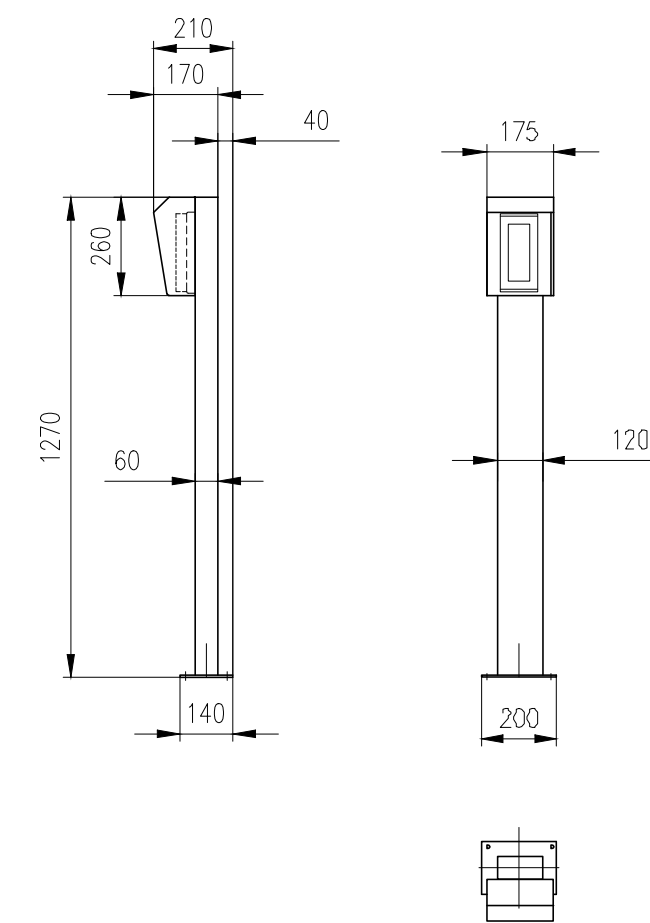

Post: HELIOS
Straight – Intercom and
RFID head holder

